



# ***HERAITAGE CONSERVATION & URBAN INFILL***

## **Pelestarian Warisan Budaya & Rancang Pengembangan Sisipan**

**IKAPUTRA**

Jurusan Teknik Arsitektur & Perencanaan, Fakultas Teknik,  
Universitas Gadjah Mada.

**KULIAH PEMBEKALAN STUDIO**

**UNIVERSITAS ISLAM INDONESIA**

**28 Agustus 2010**



Diskusi kita kali ini terkait dengan  
*"Heritage Conservation & Urban  
Infill"* kan ? Kira-kira garis besar  
isinya apa ya?

Ada baiknya kita mulai dari Apa itu *"Heritage"*?  
Lalu kita bisa membicarakan *"Mengapa Heritage itu  
Penting?"*  
Dilanjutkan dengan Penyebab Kerusakan *"Heritage"*?  
*Tujuan Heritage Conservation.....*

Baru kemudian kita bicarakan tentang *"Apa itu Infill  
Development"....*

Terakhir tentu Contoh-contoh *"Urban Infill Development"*  
pada tapak Warisan Arsitektur.....

Wah bakalan panjang ya....?

# Apa itu Heritage Pusaka Budaya?

	Definisi yang dinyatakan dalam Konvensi atau Perundangan	UNESCO's Convention 1972	Japan Law For cultural Properties	UU no 5 1992 ttg Cagar Budaya
Continuing Past Tradition	Things			
	Practices			
Type of Heritage	Cultural Heritage			
	Natural Heritage			
Scale of Heritage	Art & Skill Heritage			
	Parts of Property			
	Art works			
	Monument			
	Group of Buildings			
	Sites			
Characteristic	Tangible			
	Intangible			
	Moveable			
	Immoveable			
Age	More than 50 years			
Significance	Outstanding universal value			
	Historic value			
	Aesthetic/Unique/Artistic value			
	Scientific value			
	Ethno-anthropological value			
	Archeological value			
	Cultural value			
	National value			



**Apa itu**  
***Heritage***  
**Pusaka**  
**Budaya?**





**Apa itu**  
***Heritage***  
**Pusaka**  
**Budaya?**



**Apa itu  
*Heritage*  
Pusaka  
Budaya?**





**Apa itu  
*Heritage*  
Pusaka  
Budaya?**



**Apa itu  
Heritage  
Pusaka  
Budaya?**





**Apa itu  
Heritage  
Pusaka  
Budaya?**





**Apa itu  
*Heritage*  
Pusaka  
Budaya?**





**Apa itu  
*Heritage*  
Pusaka  
Budaya?**



**Apa itu  
Heritage  
Pusaka  
Budaya?**





**Apa itu  
*Heritage*  
Pusaka  
Budaya?**



# Mengapa Heritage Penting?

*Uniqueness, originality, outstanding, historic specific, ethno-anthropological difference, distinguished aesthetic/artistic, scientific value etc.*

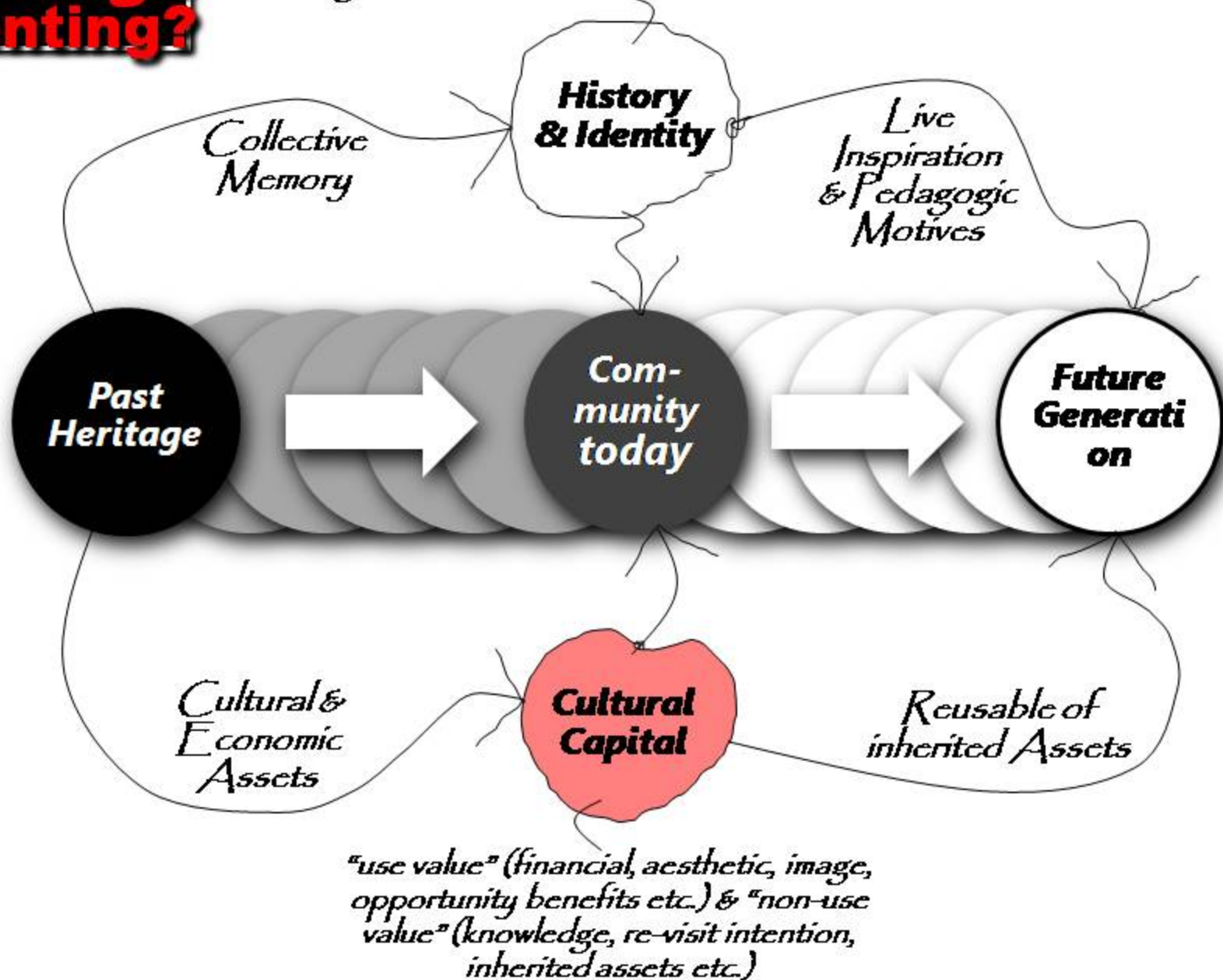



**“Nilai Guna”** adalah  
keuntungan-keuntungan yang didapat dari  
penggunaan langsung maupun tidak langsung  
dari suatu situs pusaka budaya

**Heritage  
As Cultural  
Capital**

- Keuntungan finansial dari nilai sewa aset-aset budaya;
- Kualitas estetis dari pusaka budaya yang bisa dinikmati langsung oleh wisatawan yang berkunjung;
- Meningkatkan Citra Masyarakat karena keberadaan suatu pusaka budaya;
- Kesempatan untuk menggunakan situs pusaka budaya untuk tujuan-tujuan bagi suatu pemukiman, komersial, wisata, rekreasi dan kepentingan masyarakat.

**“Nilai Non-Guna”** adalah  
manfaat tak langsung yang terkait dengan upaya  
pelestarian pusaka budaya tanpa harus  
menggunakan asset tersebut

- Nilai Eksistensi (Existence value): Manfaat terkait dengan pengetahuan tentang upaya pelestarian suatu situs warisan budaya, tanpa seseorang yang dianggap sebagai “konsumen pengetahuan” harus mengunjungi secara langsung;
- Nilai optional (Option value): Manfaat dari timbulnya keinginan seseorang untuk merencanakan suatu opsi berkunjung ke suatu situs pusaka budaya di masa mendatang;
- Nilai Warisan (Bequest value): Nilai manfaat yang dipahami bahwa situs pusaka budaya dapat diwariskan kepada generasi masa depan.

# ***Heritage As Cultural Capital***

**“Nilai Guna”** adalah  
keuntungan-keuntungan yang didapat dari  
penggunaan langsung maupun tidak langsung  
dari suatu situs pusaka budaya







# **Heritage As Cultural Capital**

**“Nilai Non-Guna”** adalah manfaat tak langsung yang terkait dengan upaya pelestarian pusaka budaya tanpa harus menggunakan asset tersebut



# ***Heritage As Cultural Capital***

**“Nilai Non-Guna”** adalah  
*manfaat tak langsung yang terkait dengan upaya  
pelestarian pusaka budaya tanpa harus  
menggunakan asset tersebut*





# Penyebab Kerusakan Heritage

## Cause of Decay, Deterioration, Destruction

## Possible Conservation Approaches

Natural Process of Decay

Maintenance, Preservation, Restoration

Human Cause of Decay

Preservation, Restoration, Conservation, Adaptation, Reconstruction

Technical Cause of Deterioration

Restoration, Retrofitting, Reconstruction

Natural Disaster Cause of Damage

Restoration, Retrofitting, Reconstruction

the greatest cause of heritage decay

Earthquake causes devastating destruction & mostly irreparable damage of historic buildings & works of art.

Unpredictable earthquake occurrence

Earthquake

Heritage Preparedness for earthquake

Future Earthquake

Heritage is in Very low priorities in post-earthquake operation comparing to humanitarian program because of considerably more expensive reconstruction cost

Integrating efforts to improve the seismic resistance of historic buildings into a regular planning program



*Stasiun Lempuyangan.....  
Ulah Putting Belung*



# TIPOLOGI ARSITEKTUR STASIUN



*Stasiun Semut.....  
Ulah Investor Superblock...*



*Kesawan Medan.....  
Ulah Pengusaha Sarang Wal*





*Borobudur....  
Ulah Pengunjung "berpayung"*





*Bended Pyramid.....  
Kesalahan Teknis.....*





*Bended Pyramid.....  
Ulah.....Expertise???*

# Tujuan Heritage Conservation

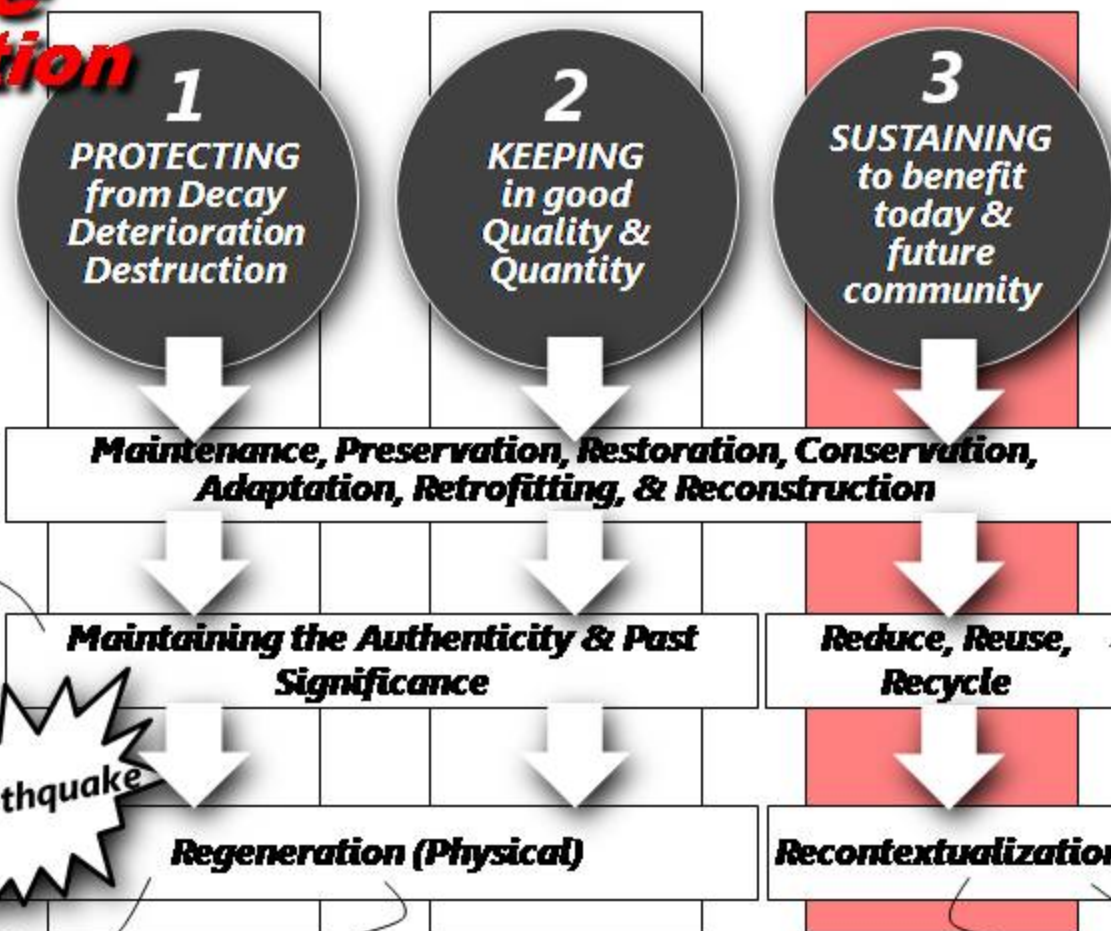

*Redefining  
Heritage based  
on physical  
regeneration  
in term of  
anticipating  
the Earthquake*



*Renewing  
the "non-surviving" parts  
(physical) against  
future earthquake*

*Redefining  
Heritage  
based on  
Sustainability*

*Renewing  
the context for the  
heritage to sustain its  
significance.*





Pengertian "*Infill Development*" nya mana?  
Keburu buka puasa lho!!



Ok.....ok segera-segera?

siiip...?

# DASAR RASIONAL PEMBANGUNAN SISIPAN (INFILL DEVELOPMENT)

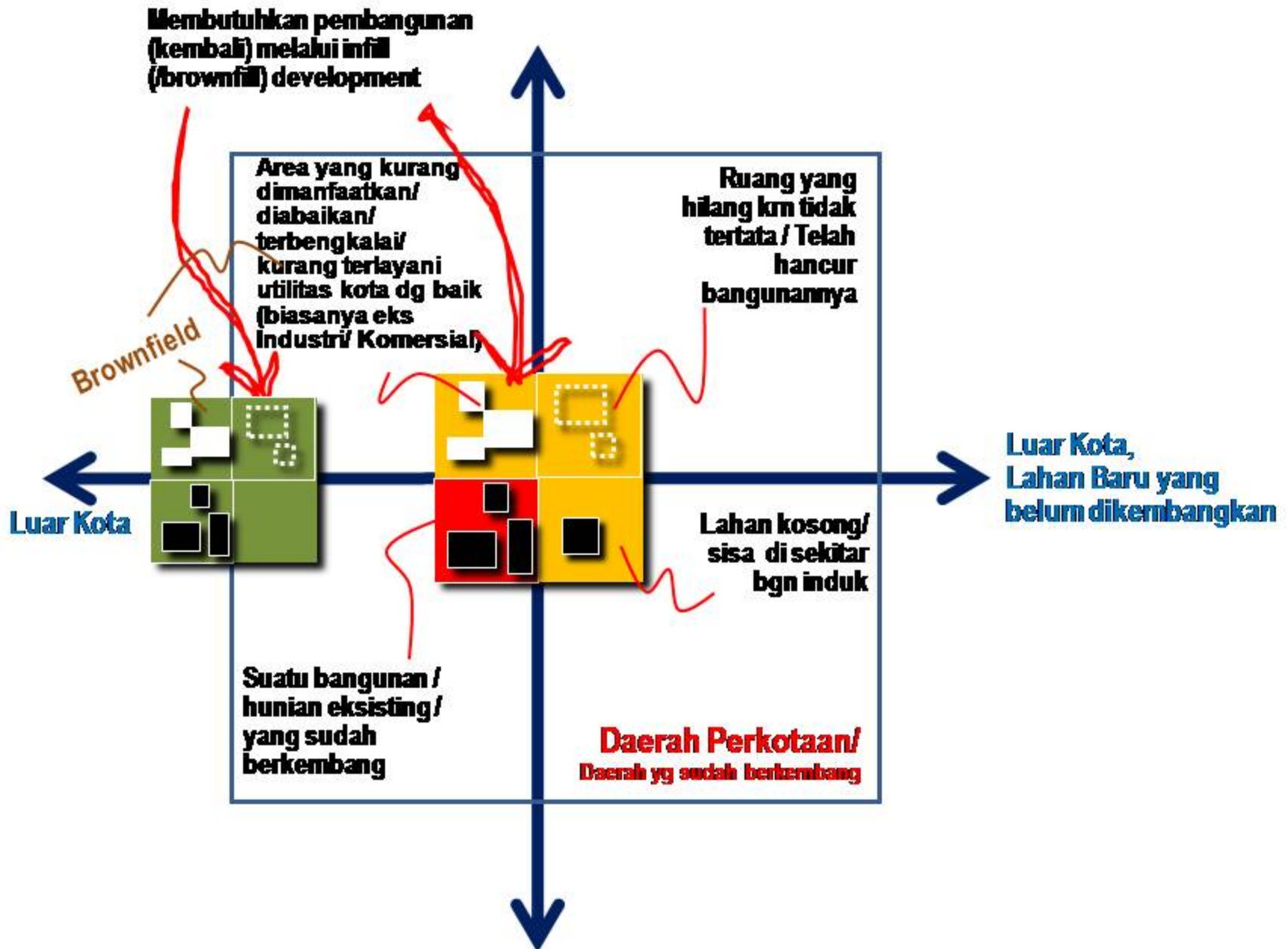



# PRINSIP-PRINSIP PEMBANGUNAN SISIPAN (INFILL DEVELOPMENT)

## KONTEKSTUAL

Mendukung Efisiensi Fungsi di masa datang

Membuat Pembangunan Ekonomi yg lebih baik

Menyediakan stok lahan untuk pembangunan

Membuat Kompaksi Wilayah Kota yang mudah dicapai

Berkontribusi dlm pembentukan identitas kota

Menciptakan lebih banyak ruang terbuka hijau (RTH)

Menghargai SITE (Penggunaan & Morfologi)

Menghargai BENTUK (Karakter & Tipologi)

Menghargai IDENTITAS (Keindahan seni dan budaya komunitas)

Menghargai KEPADATAN (Kekompakan & efisiensi lahan)

Menghargai KEAMANAN & KESELAMATAN

Menghargai Kualitas Lingkungan (RTH, penggunaan kendaraan tidak bermotor/ angkutan umum massal)

Untuk Keberlanjutan di Masa Depan

Mencegah:

- hilangnya amenitas
- hilangnya nilai-nilai ekonomis
- hilangnya jaringan ruang hijau
- hilangnya ruang antar bangunan
- hilangnya sinar matahari
- hilangnya jalur pedestrian & parkir, dll

EFISIENSI & EKONOMI

EKOLOGI

ESTETIKA & BUDAYA

ELABORASI KESELAMATAN LINGKUNGAN

MENINGKATKAN  
EKSISTING

Sumber:  
1) *The Infill and Redevelopment Code Handbook*. Oregon Department of Land Conservation and Development. 1999  
2) *Planning and Urban Design Standards*. Frederick R. Steiner and Kent Butler. 2008

# PEMAHAMAN PEMBANGUNAN SISIPAN (INFILL DEVELOPMENT) PADA LINGKUNGAN PERMUKIMAN PERKOTAAN TERBANGUN

## Skala Makro

Sebuah upaya pemanfaatan lahan (kecil ataupun skala besar) pada kawasan terbangun atau memiliki lingkungan eksisting terbangun yang kuat, ditunjukkan melalui struktur kawasan yang jelas dan atau melalui permanensi bangunan-bangunan eksisting, pada suatu kawasan permukiman, industri, komersial, dan kawasan perkotaan lainnya, atau pada kawasan terbangun di luar kota.

## Skala Messo

Pembangunan Sisipan dilakukan jika kawasan terbangun tersebut terbelah karena fisik bangunan atau lahan yang rusak ataupun kawasan yang tidak terkendali pembangunannya, sehingga membutuhkan upaya penataan, pembangunan kembali, dan atau pemanfaatan kembali bangunan serta lahan tersebut untuk memperkuat/ memperbaiki citra lingkungan dalam rangka mewujudkan:



- 1) Kompakitas/ intensitas struktur dan bentuk kawasan (*making compact accessible city*),
- 2) Peningkatan efektifitas peran dan fungsi kawasan (*supporting future efficient function including economic devevelopment*),
- 3) Peningkatan utilitas kawasan termasuk keselamatan dan keamanan kawasan
- 4) Peningkatan kualitas ekologi kawasan (*green environment*), dan
- 5) Penciptaan identitas kawasan (*city identity*).

## Skala Mikro

Pembangunan sisipan dilakukan pada tingkat batas kepemilikan persil atau lahan, jika pemanfaatan persil tersebut akan mempengaruhi kualitas kawasan secara keseluruhan seperti persil-persil dalam kawasan permukiman. Persil-persil tersebut menjadi cukup kritis jika tidak secara efisien termanfaatkan (bangunan rusak/lahan terbelah) atau persil-persil terbangun yang masih menyisakan ruang terbuka yang bisa disisipi bangunan secara proporsional dan ekologis.



# PENDEKATAN PENYUSUNAN PEDOMAN PEMBANGUNAN SISIPAN (INFILL DEVELOPMENT) DI LINGKUNGAN PERMUKIMAN PERKOTAAN TERBANGUN

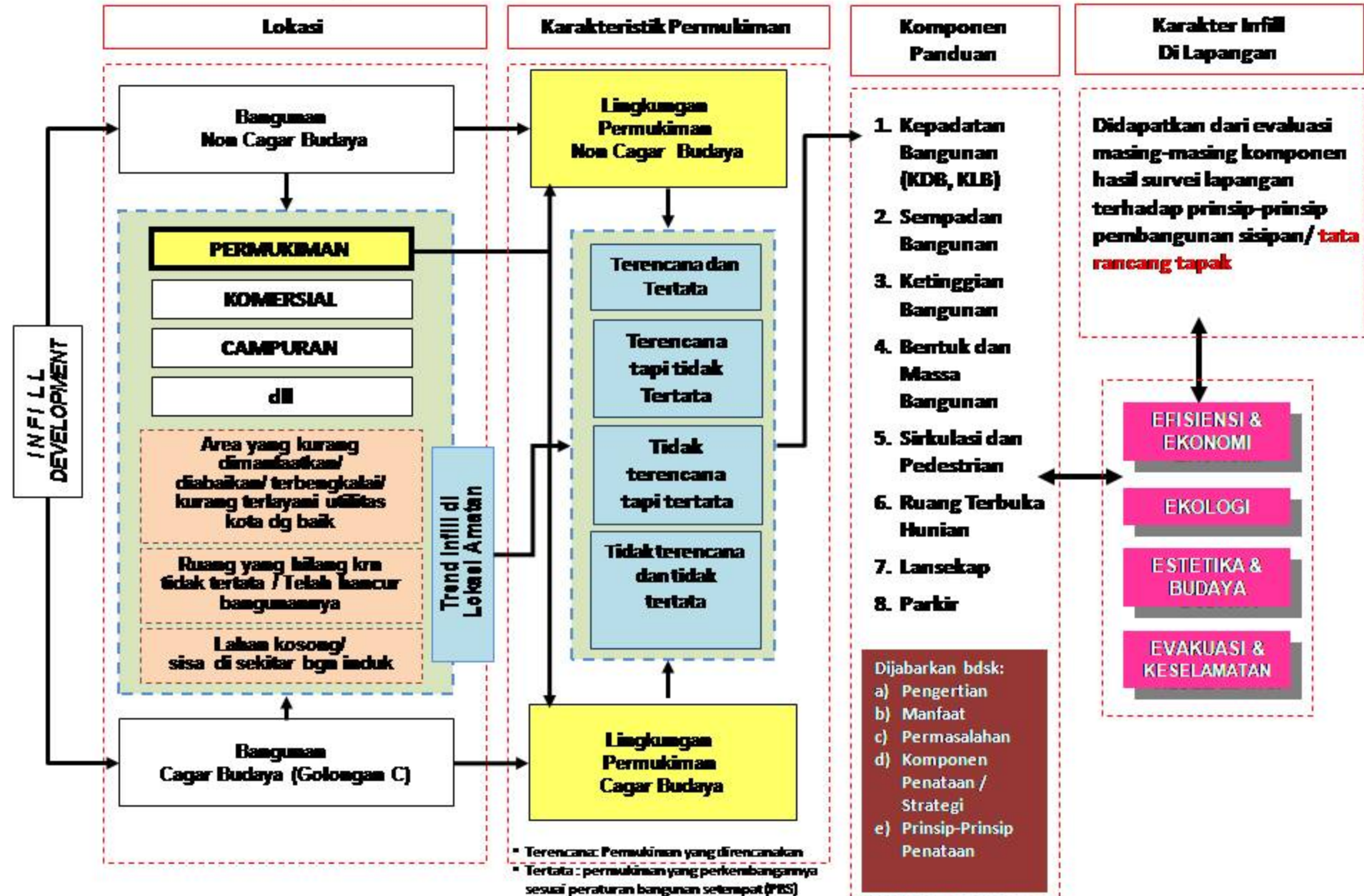



**Apa sebenarnya arti penting “*Infill Development*” ?**

**Sebenarnya, kalau kita memperhatikan prinsip2 *Infill Development* secara sungguh-sungguh kota kita akan, Estetis, Efisien & Efektif pemanfaatannya, Ekologi & Budayanya berkualitas, dan kehidupan kita akan terelaborasi dengan keselamatan lingkungan?**

**Jadi yang 4 EEEE tadi ya...?  
Kenyataannya gimana???**



# ***Infill Development vs Design?***

**Efisiensi vs Estetika?**



**Masalah Efisiensi vs Estetika?**



**Masalah Ekologi, Estetika, vs Efisiensi?**



Foto: Pak Iwan

**Estetika, Ekologi, & Efisiensi kawasan?**





# ***Infill Design for Heritage Architecture?***

**Masalah Estetika, Efisiensi,  
Ekologi (RTH)?**



**Masalah Estetika Heritage?  
Efisiensi?**



**Masalah Estetika Heritage?  
Skyline? Efisiensi?**



**Masalah Estetika Heritage?  
Skyline?**





# ***Infill Design? Architectural Addition***







***Infill Design Proportion?***  
**Efisiensi vs Estetika**



***Infill Design & Konteks  
Kawasan?***

***Efisiensi vs Estetika***





Kota Taiping 1960

## ***Infill Design & Konteks Kawasan?***

***Efisiensi vs Estetika  
vs ekologi?***



Kota Taiping 2005



***Sisipan  
pada  
kawasan***

***Efisiensi?  
Estetika?***



# ***Kawasan Taman Sari Sisipan pada Kawasan***

***Efisiensi?  
Ekologi?  
Estetika?***

**The collapse of Taman  
Sari Water Castle by  
Earthquake 1867**



***Taman Sari  
Water castle***  
(An image reconstruction  
before earthquake 1867)

***Taman Sari  
Water castle***  
(Photo taken in 1992)





# KOMPONEN RANCANGAN PEDOMAN PEMBANGUNAN SISIPAN (INFILL DEVELOPMENT)



Apa yang perlu  
diperhatikan dalam  
*Infill Design*?

EFISIENSI &  
EKONOMI

EKOLOGI

Bentuk & Massa  
Bangunan

KLB

Sirkulasi & Pedestrian

ELABORASI  
KESELAMATAN  
LINGKUNGAN

Parkir

ESTETIKA &  
BUDAYA

Sempadan Bangunan

Ketinggian  
Bangunan

Lansekap

KDB

Ruang  
Terbuka Hijau

Ada komponen Rancangan dalam  
*Infill Design*



**KDB**

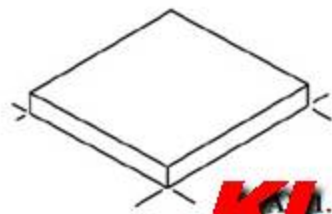
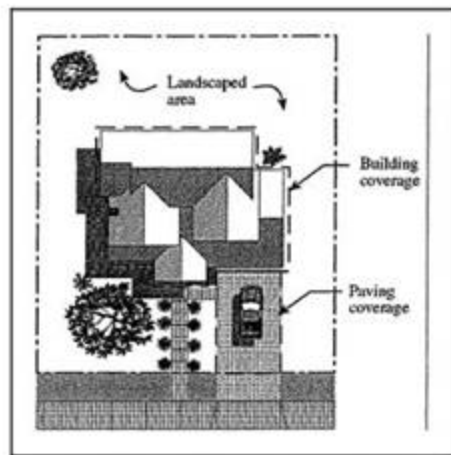

**KLB**

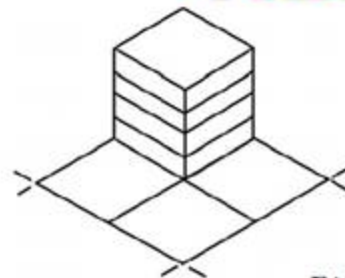

FAR 1.0

**KDH**

Bangunan  
(KDB)

Ruang Terbuka  
(KRT)

Daerah Hijau  
(KDH)

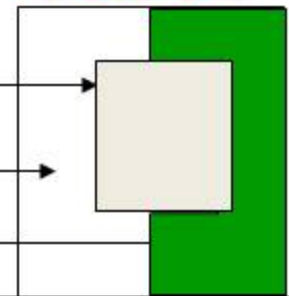

Jalan

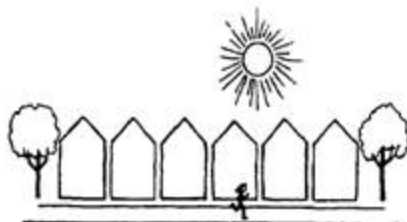

Ketinggian bangunan yang membentuk keselarasan & hamonisasi bentuk

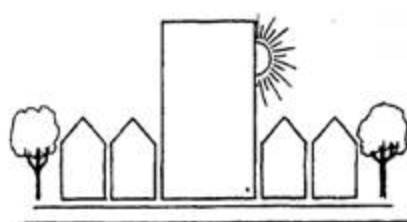

Ketinggian bangunan yang tidak membentuk keselarasan & hamonisasi bentuk

**Tinggi bangunan**

**Sempadan Bangunan**

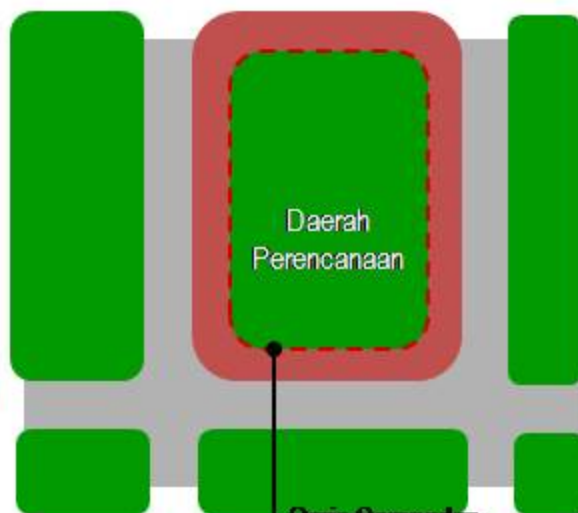

Garis Sempadan Bangunan

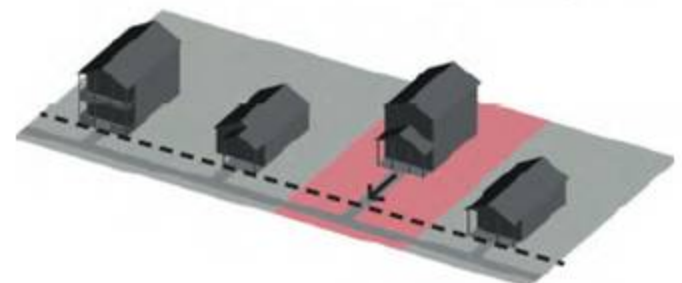
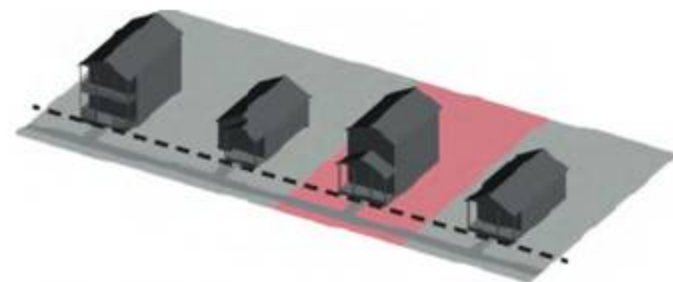

Sempadan bangunan menciptakan keselarasan fasade (atas), sempadan bangunan yang terlalu jauh mengurangi keselarasan fasade (bawah)



# INFILL DEVELOPMENT: Bentuk & Massa bangunan

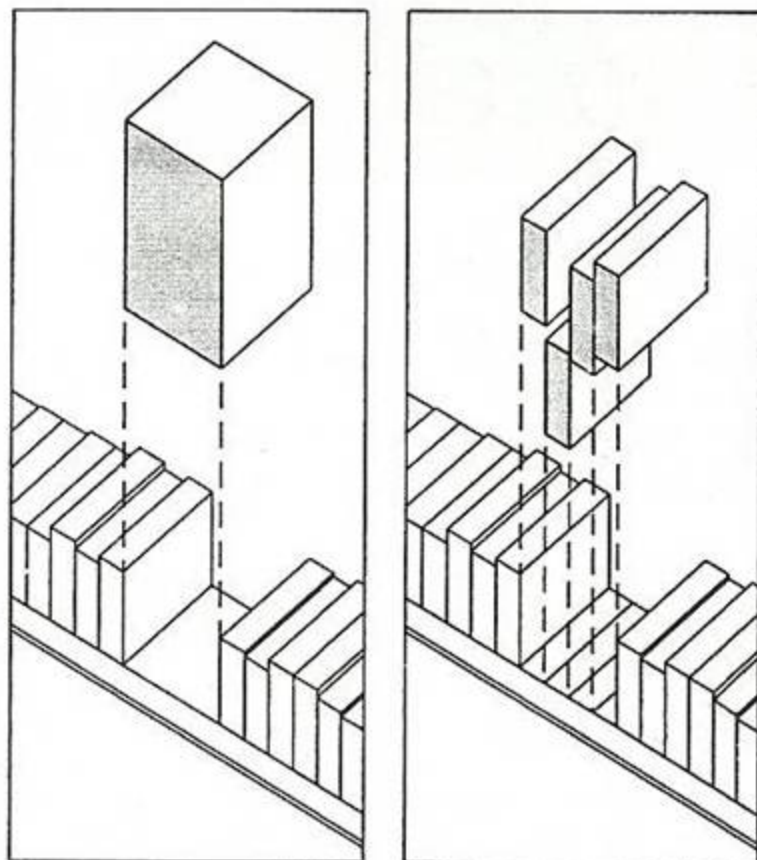

**Incompatible Massing**      **Compatible Massing**

Articulate massing to ensure the façade is compatible with surrounding buildings.

## INFILL MASSING

Source: SMWM.

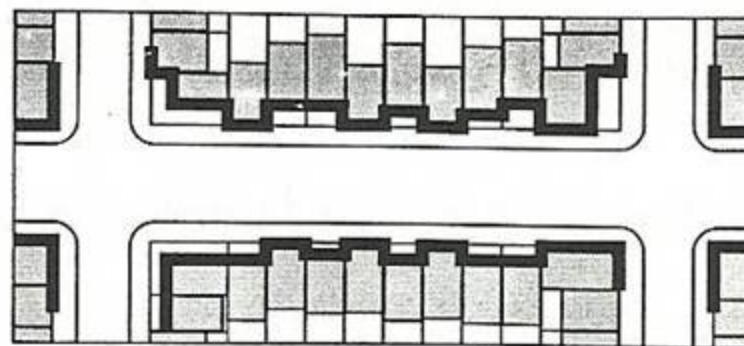

**Inconsistent Façade**

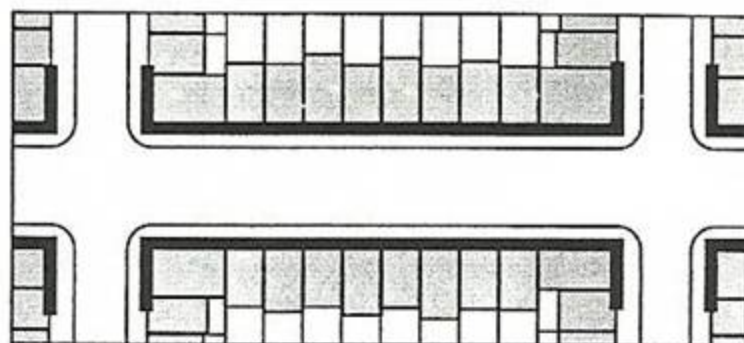

**Consistent Façade**

Maintain ground-floor façade within an infill project to define a consistent street edge.

## STREET EDGE

Source: SMWM.

# INFILL DEVELOPMENT

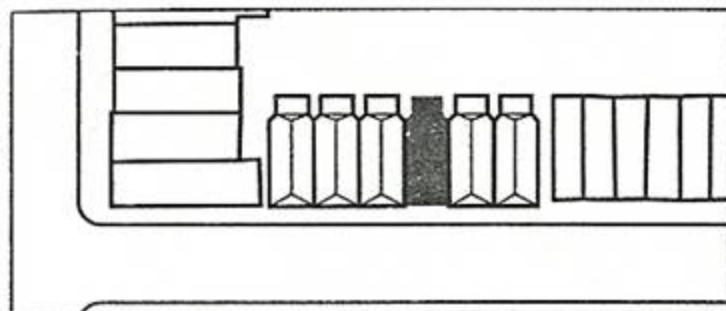

**Single-Lot Infill**

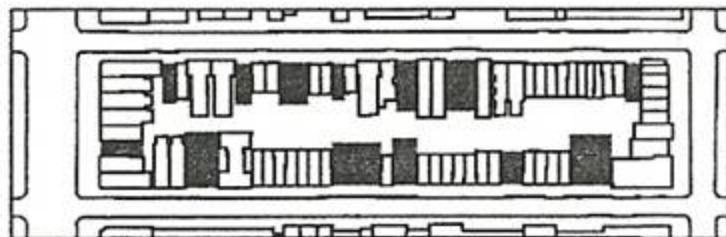

**Multiple-Lot Infill**

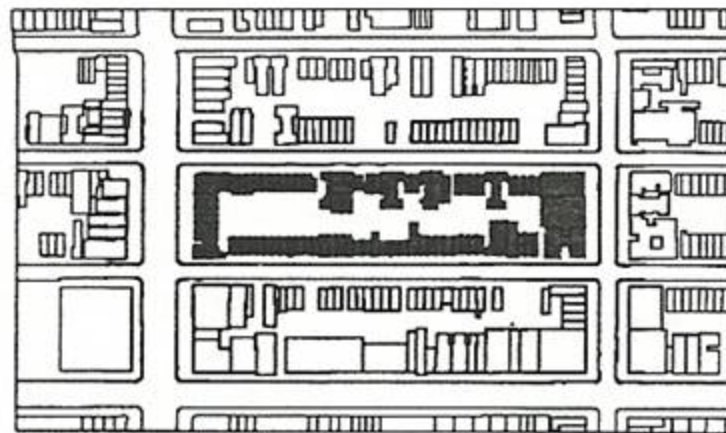

**Block Infill**

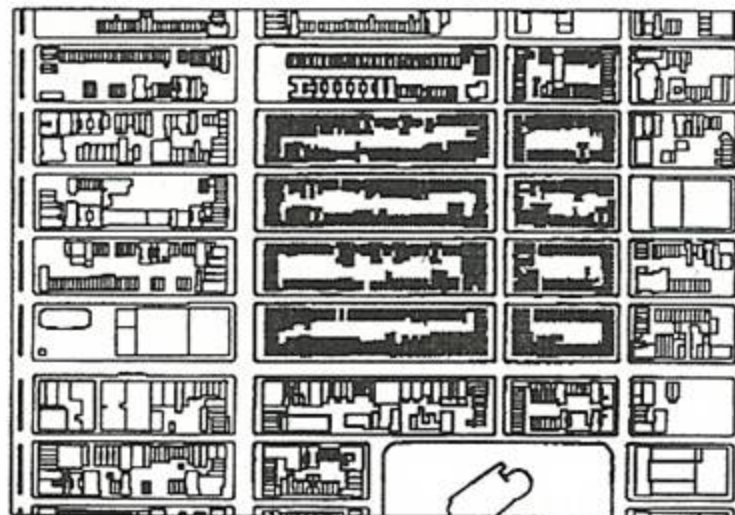

**Multiple-Block Infill**



**Downtown Area Infill**

Infill projects can range significantly in form and size, from single- or multiple-lot development in a neighborhood to entire blocks or districts.



# "DUALITY: OLD-NEW"

Contoh Phenomena "Urban Infill"  
pada Warisan Arsitektur yang  
paling sering terjadi seperti apa ya?

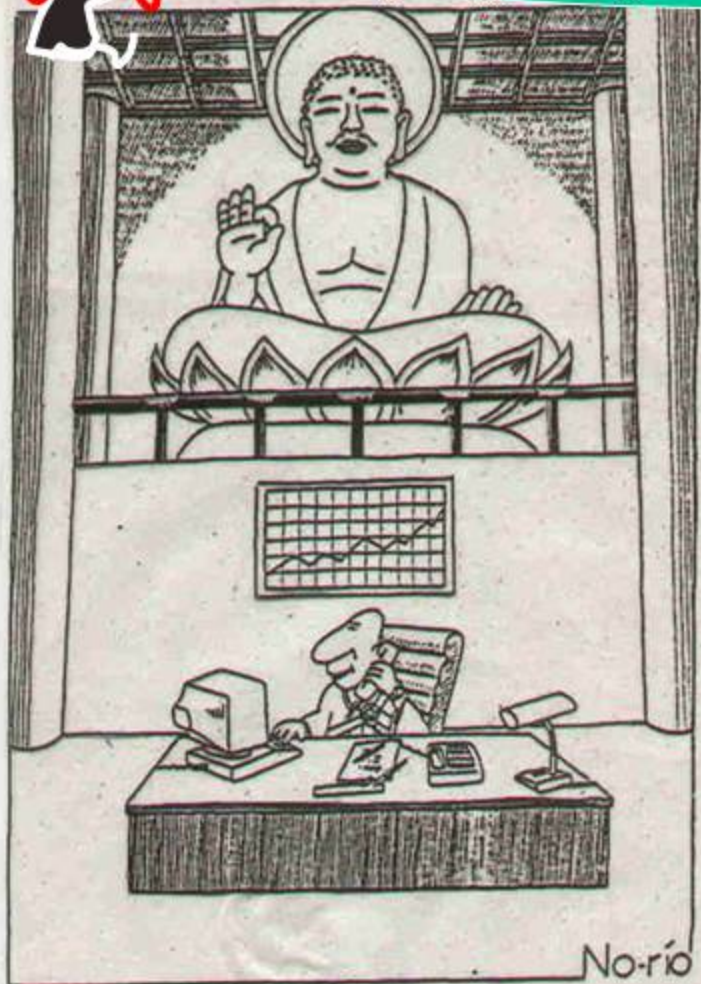

Dualitas Budaya atau  
Phenomena "Old" and "New"  
menjadikan suatu elemen  
Budaya menjadi Unik  
termasuk Karya  
Arsitekturnya.....



# Tradition “versus” Modern





# Tradition “within” Modernity



# *The path from* **“tradition”**





# “Both-and” NOT “Either-or”



# Old & New Symbioses everywhere

*Phenomena Lama dan Baru  
menjadi bagian budaya dunia ya?*



**Sebanarnya Potret sehari-hari yang kita  
lihat menjadi Fakta tak terbantahkan...**



## ***Tradition-Modern Symbioses***



# “Old” and “New” (salad bowl)





# “Old” and “New” (salad bowl)

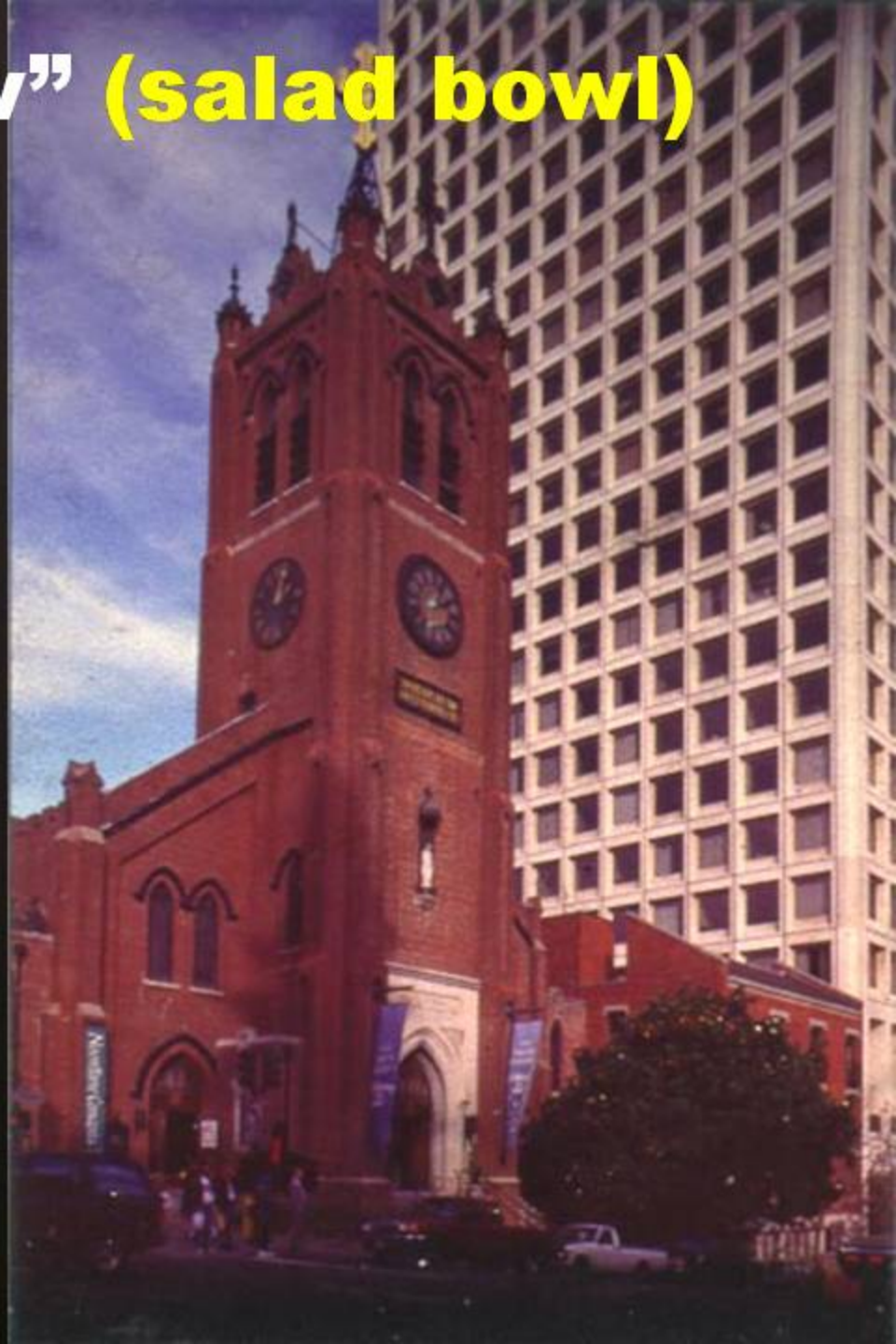

# “Old” and “New” (salad bowl)





# “Old” and “New” (salad bowl)



# **“Old” and “New” (Naive)**





# **“Old” and “New” (Contextual)**



# “Old” within “New” (*Framing*)

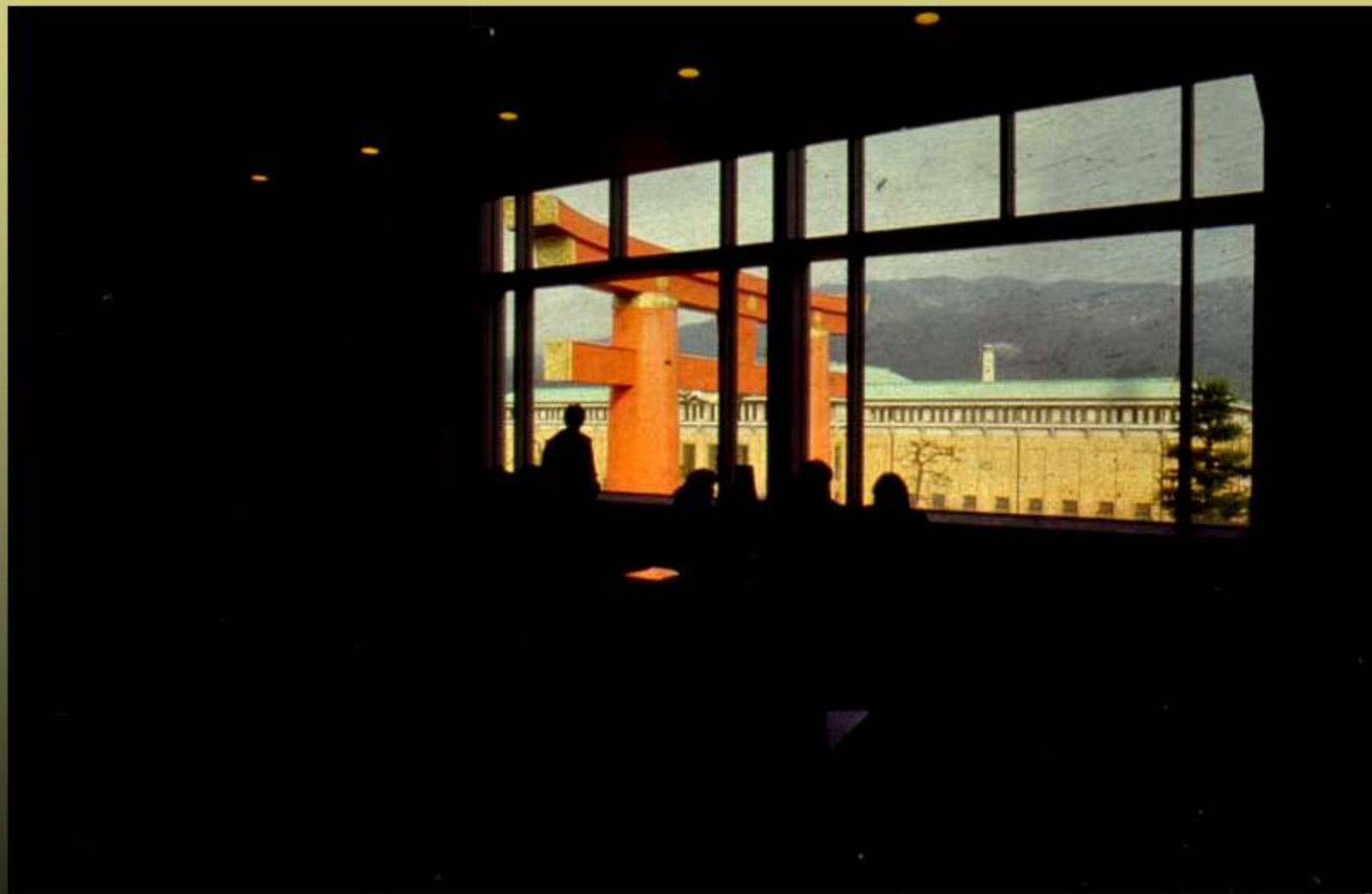



# **“Old” and “New” (Global context)**





# Preserving Traditional façade





# Modernizing the interior





Upaya "*Infill Development*"  
dilakukan ketika suatu pusaka  
arsitektur telah rusak, hancur  
karena bencana ya?

Betul Gempa Yogyakarta salah satu  
contohnya...



# Sejarah Gempa Bumi Yogyakarta 1867-2009

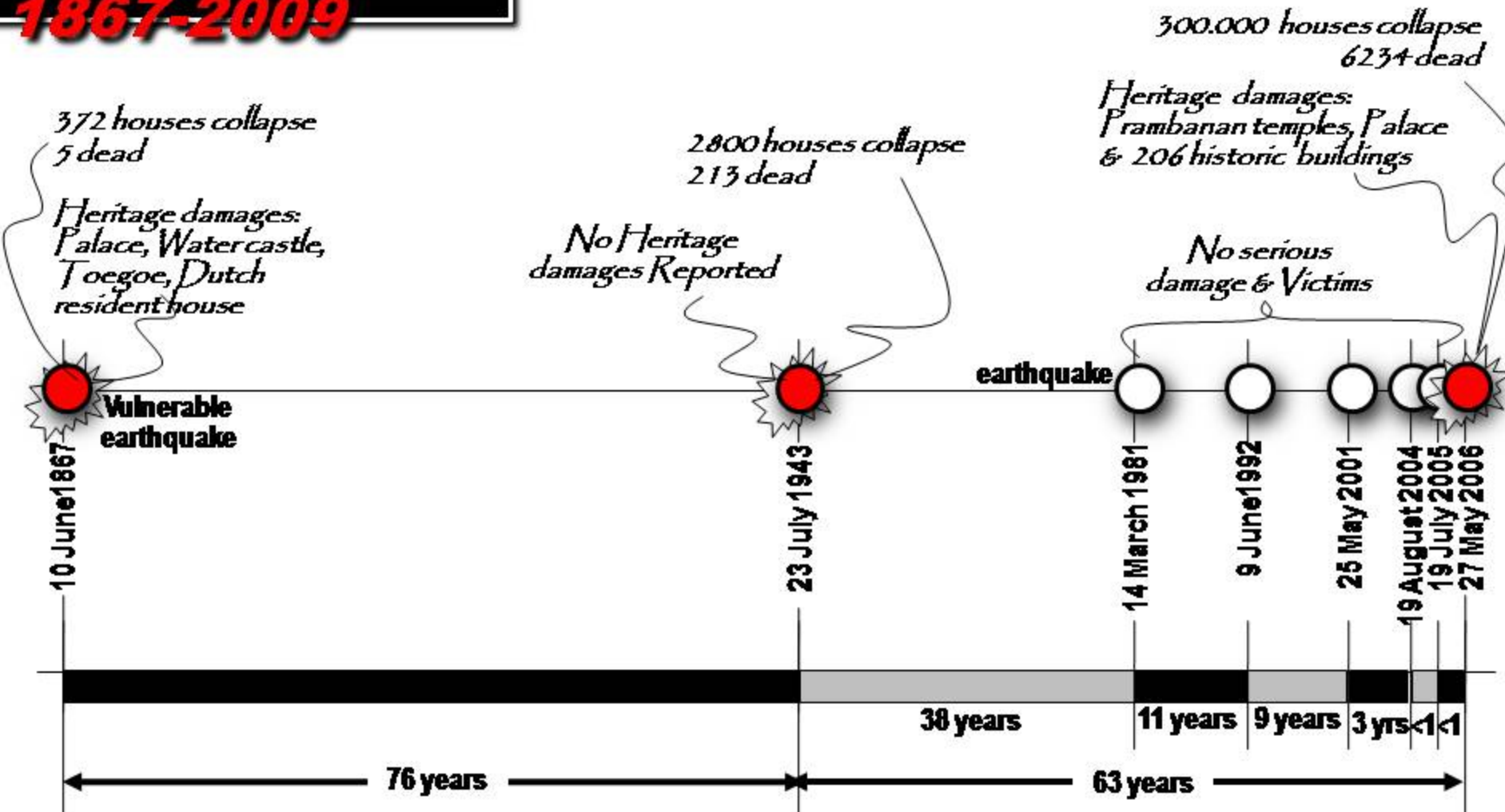

# Kerusakan Warisan Budaya DIY Pre-Post Earthquake 2006

Modifikasi: Kondisi Umum Kekayaan Budaya DIY: 2007

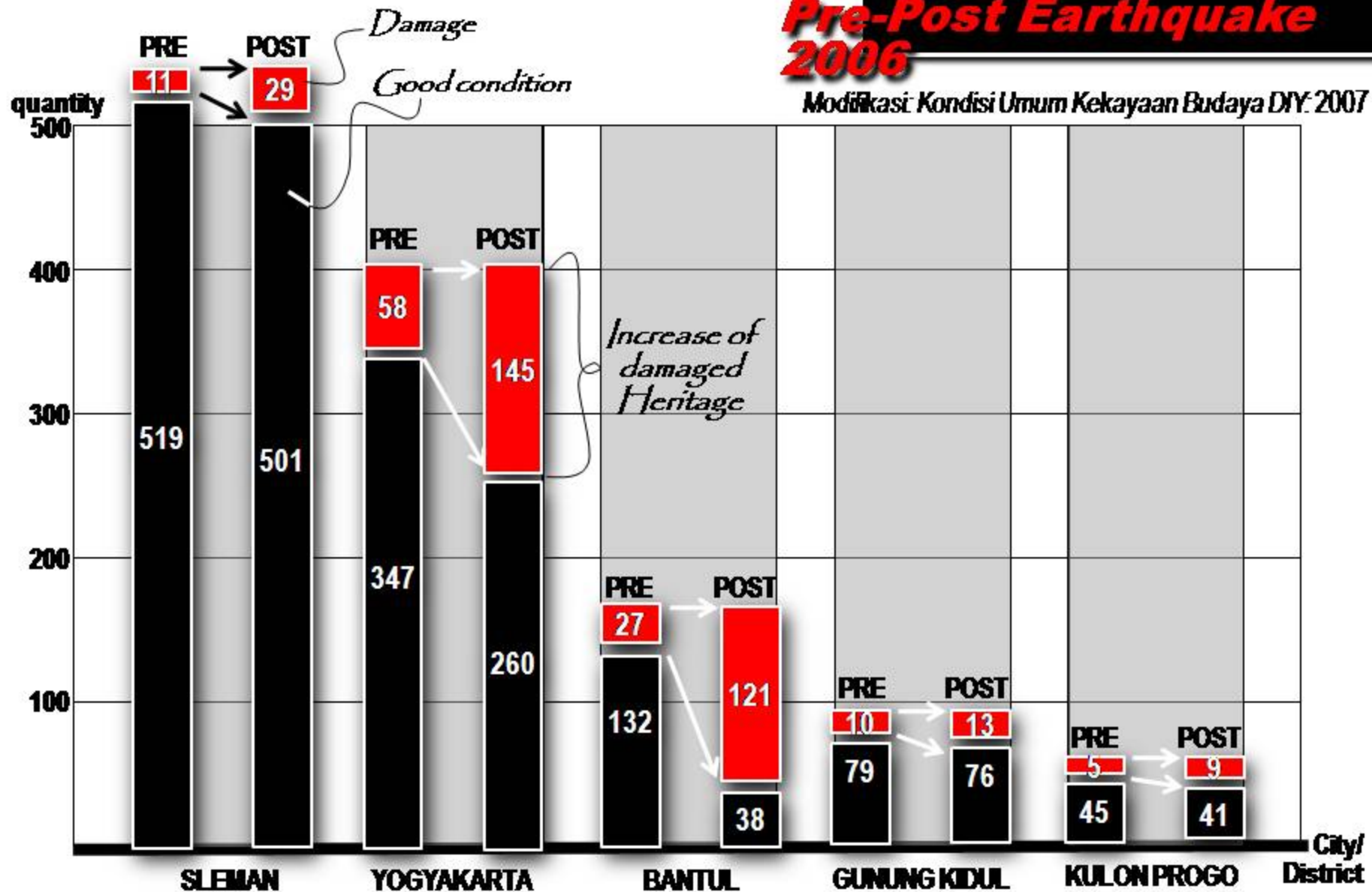



# Javanese Traditional House (Dalem)

## The Difference among dalems

## Dalem's Typology: From Aristocratic House to Village leader house



**Dalem Pangeran:** Noble's Residence



**Dalem:** High rank aristocratic house



**Dalem:** village leader house

### Dalem Pakuningratan

### Dalem Kaneman

### Dalem Yudoningratan

### Dalem Pengulon

### Dalem



**Dalem Pangeran**  
Noble Residence

**Dalem Pangeran**  
Noble Residence

**Dalem**  
High rank Aristocratic  
Residence

**Dalem**  
Rich People  
House

**Dalem Pangeran**  
Noble Residence

More Green & Open Space

### Dalem Basic Components



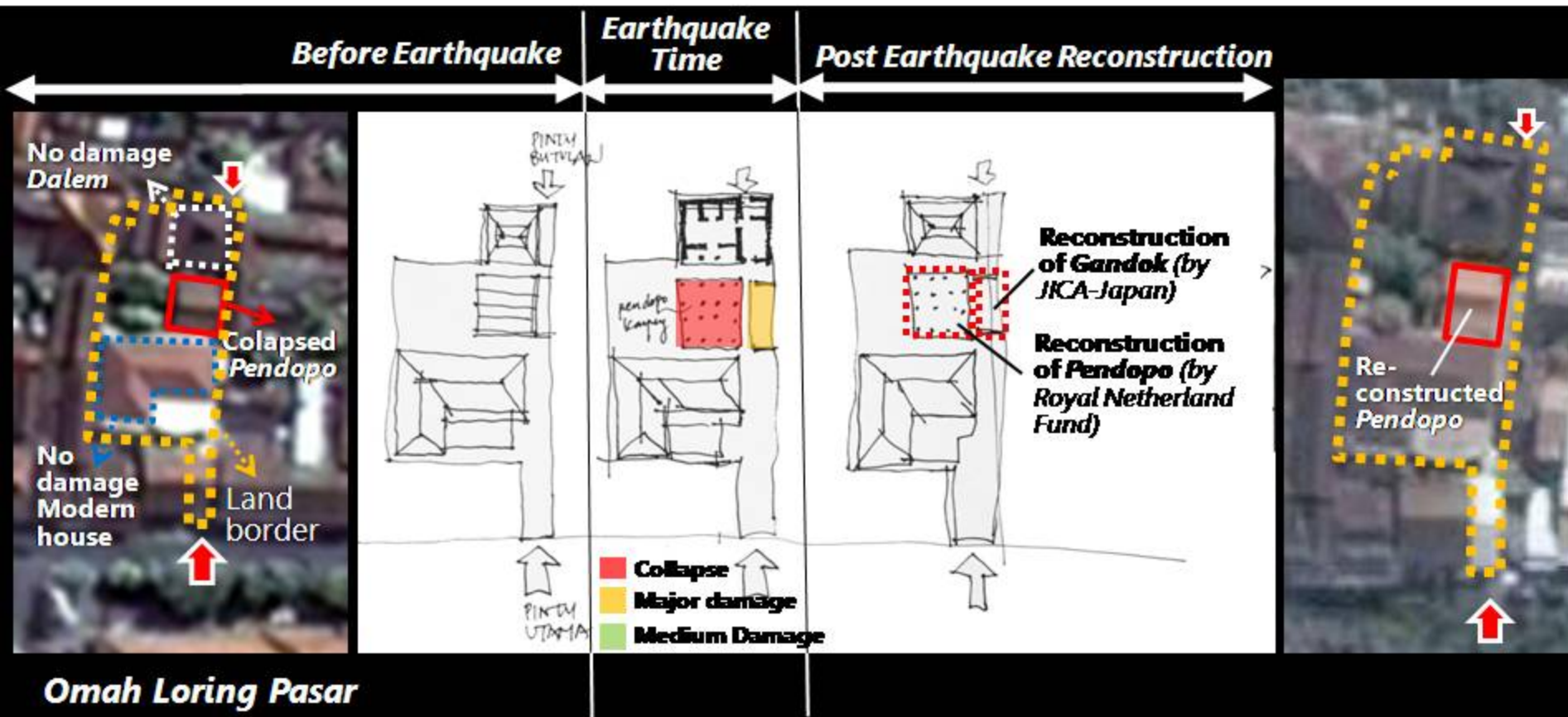

## Langkah 2

- Bikin sketsa free hand
- Gambar situasi (tampak atap)



The House  
at North of Market

## Omah Loring Pasar

**Heritage Foster Parent's Program  
for Kotagede's Folk House**

### Omah Loring Pasar

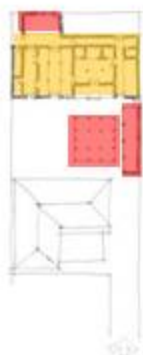
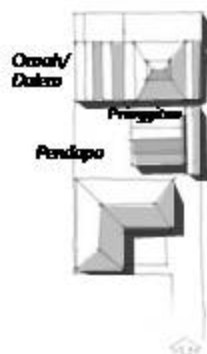

Refurbishing Omah/  
Dalim (owned fund)

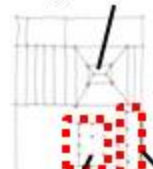

Re-  
construction  
of Veranda  
(by JICA  
Japan)

Reconstruction of  
Pondapa (by Royal  
Netherlands Fund)



July 2006



July 2006



Photo Courtesy CHC-UGM

July 2007



Lecture by Community  
for Graduate students  
at Omah Loring Pasar  
Post Reconstruction

**Supported by: Royal Netherland Fund & JICA (Japan)**

**Before Earthquake**

**Earthquake Time**

**Post Earthquake  
Reconstruction**

No damage  
Dalem



Colapsed  
Pendopo

No damage  
Modern  
house



batas  
persil

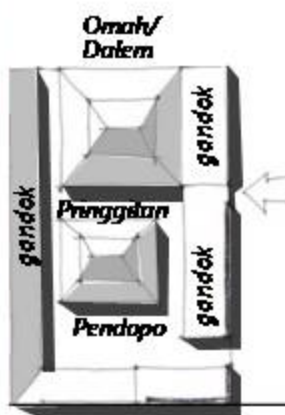

**Collapse**  
**Major damage**  
**Medium Damage**

**Retrofitting Dalem  
(owned fund)**

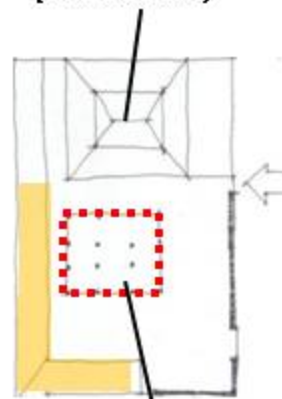

**Reconstruction  
of Pendopo (by  
Royal Netherland  
Fund)**

**Joglo Bapak Edi**



**Pendopo  
Pak Edi Priyanto**

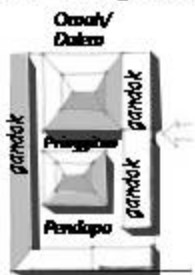

**Retrofitting Dataran  
(owned fund)**

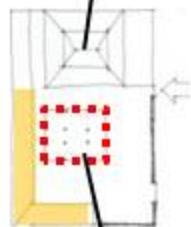

**Reconstruction  
of Pendopo (by Royal  
Netherland Fund)**



**May 2006**



**Edi's House**

**Heritage Foster Parent's Program  
for Kotagede's Folk House**



**September 2007**

**Supported by: Royal Netherland Fund**

# Joglo Bapak Mukadi

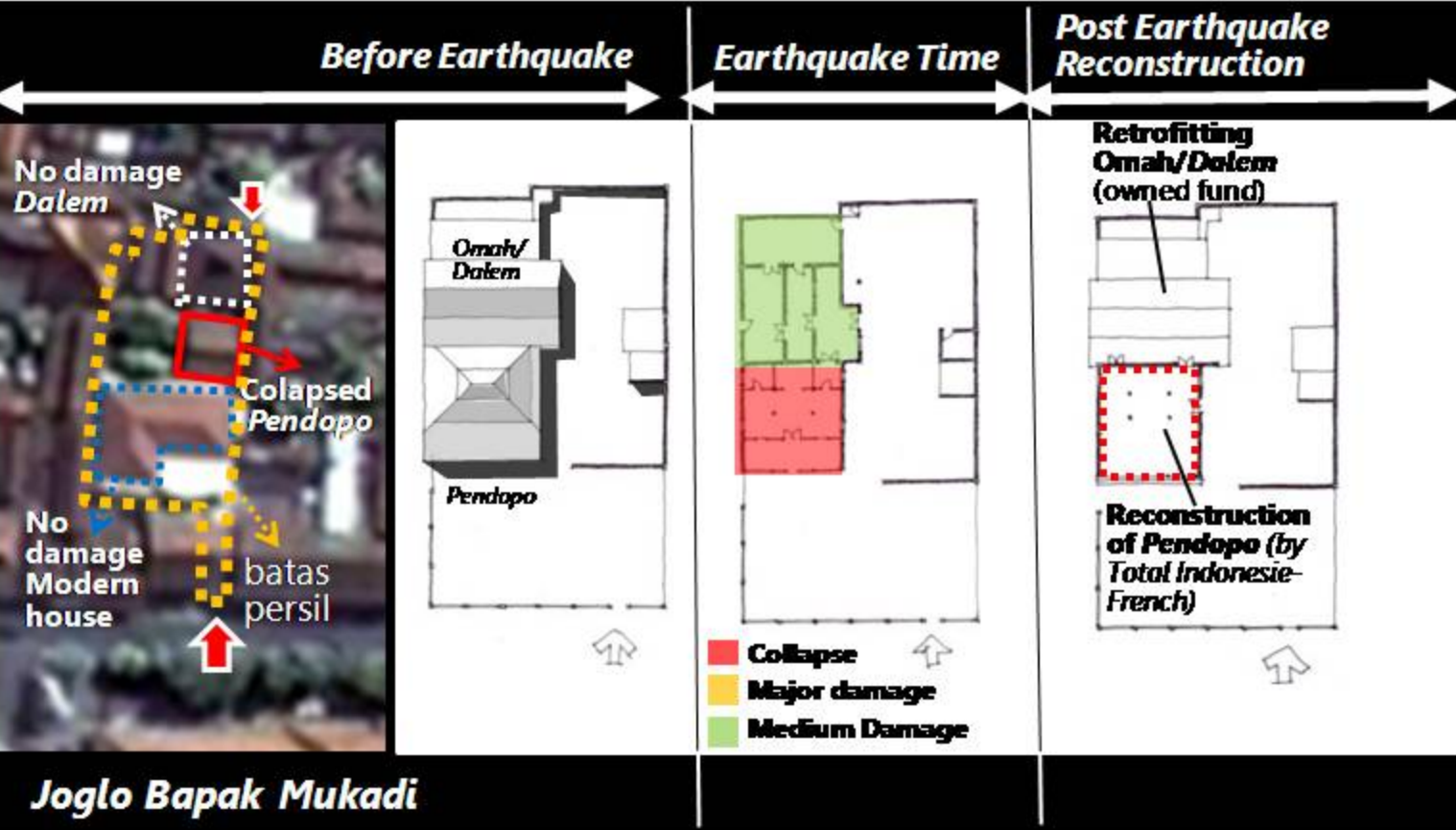



# Mukadi's House

## Pendopo Pak Mukadi

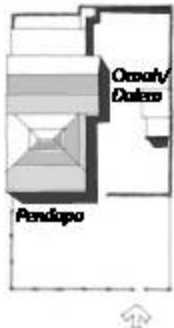

## Retrofitting Orah/Dalao (owned fund)



## Heritage Foster Parent's Program for Kotagede's Folk House



Supported by: Total Indonesie (French Oil Company)

**Before Earthquake**

**Earthquake Time**

**Post Earthquake  
Reconstruction**

No damage  
Dalem

Colapsed  
Pendopo

batas  
persil

No damage  
Modern  
house

*Gandok wingking*

*Omah/  
Dalem*

*Penggalan*

*Pendopo*

**Collapse**  
**Major damage**  
**Medium Damage**

**Retrofitting  
Omah/Dalem  
(owned fund)**

**Reconstruction  
of Pendopo (by  
Royal Netherlands  
Fund)**

**Joglo Bapak Gembong**



## Pendopo Pak Gembong

Gondok wingking

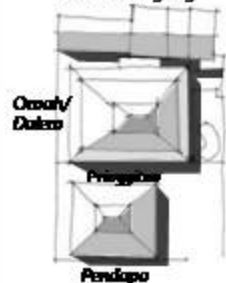

Refurbishing Omah/  
Dalem (owned fund)

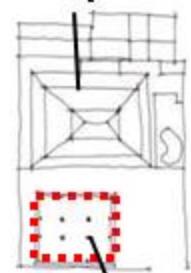

Reconstruction  
of Pendopo (by Royal  
Netherlands Fund)



**Before Earthquake** Photo Courtesy Gembong



**May 27, 2006**



**October 2006**

## Gembong's House

**Heritage Foster Parent's Program  
for Kotagede's Folk House**



**June 2009**

**Heritage Reconstruction Site :**  
As A Place for learning for  
Community, Students, & Experts

**Supported by: Royal Netherland Fund**

**Pendopo  
Pak Mukadi**



**Retrofitting  
Omah/Dalem  
(owned fund)**



**Reconstruction  
of Pendopo (by  
Total Indonésie-  
French)**

**Pendopo  
Pak Edi Priyanto**

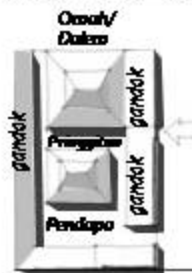

**Retrofitting Dalem  
(owned fund)**

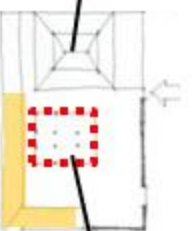

**Reconstruction  
of Pendopo (by Royal  
Netherlands Fund)**

**Pendopo  
Pak Gembong**

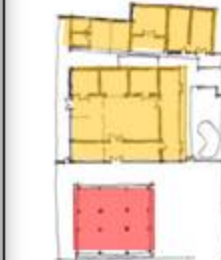
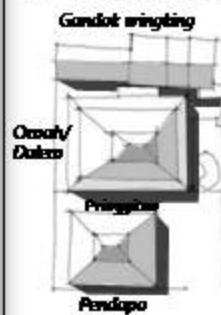

**Retrofitting Omah/  
Dalem (owned fund)**

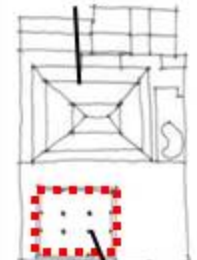

**Reconstruction  
of Pendopo (by Royal  
Netherlands Fund)**

**Omah  
Loring Pasar**

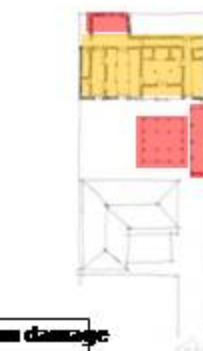
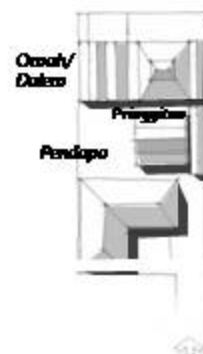

**Retrofitting Omah/  
Dalem (owned fund)**

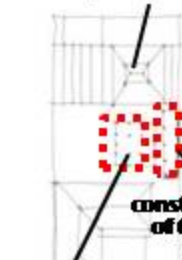

**Reconstruction  
of Pendopo (by Royal  
Netherlands Fund)**

**Omah UGM**

# Reconstructing Kotagede's Character

## Foster Parent's Program for Kotagede's Folk House/Heritage

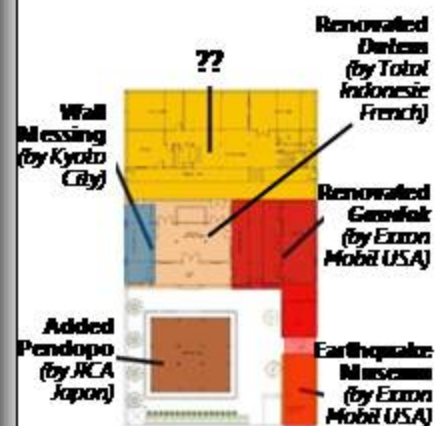



**Omah UGM**

*The House  
of UGM*

**Omah UGM**

**Heritage Foster  
Parent's Program  
for Kotagede's  
Folk House**

**2006**

*Retrofitting of the Omah  
(Total Indonesia)*

*Retrofitting of the Gandok  
(ExxonMobil)*

**2007**

*Reconstructing  
Pendopo  
(JICA-Japan)*

*Built an Earthquake  
Monument/Museum  
(ExxonMobil)*

*Preserving  
Earthquake's  
Ruins*

*Ruins*

**Earthquake Monument/Museum**  
(Design by Ikaputra)

**2008**

**Supported by: Total Indonesia (French Oil Company),  
JICA (Japan), ExxonMobil (US Oil Company)**

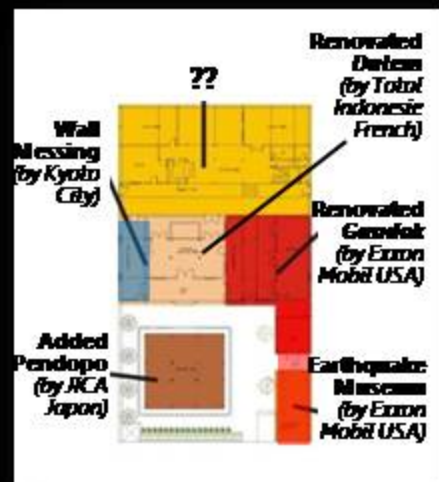



# Sejarah Gempa Bumi Yogyakarta 1867-2006

372 houses collapse  
5 dead

Heritage damages:  
Palace, Water castle,  
Toegoe, Dutch  
resident house

TUGU SOLONG GELIS



#### Keterangan:

- A. Tugu api di atas
- B. Tugu yang menjadi titik pencahayaan
- C. Tugu api di bawah
- D. Pagar
- E. Rambu-rambu navigasi







*“Infill Development”* seringkali merupakan upaya menambah... atau *“architecture addition”*... ada contohnya..



Betul... pertimbangan bentuk tapak, arsitektur eksisting, bahkan arsitektur yang dirubah menjadi pedoman-pedoman dalam penambahan arsitektur *heritage*...

# ST Peter's Basilica Change's Plan



The stadium (Circus) of Gaius (1st Century)

the early basilica of St Peter (4th Century)

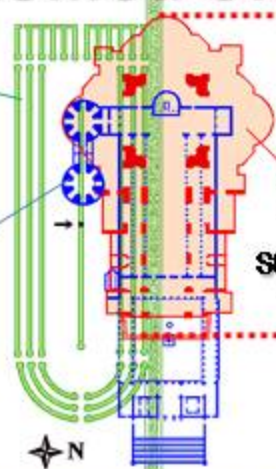

the present basilica of St Peter (16-17th Centuries)

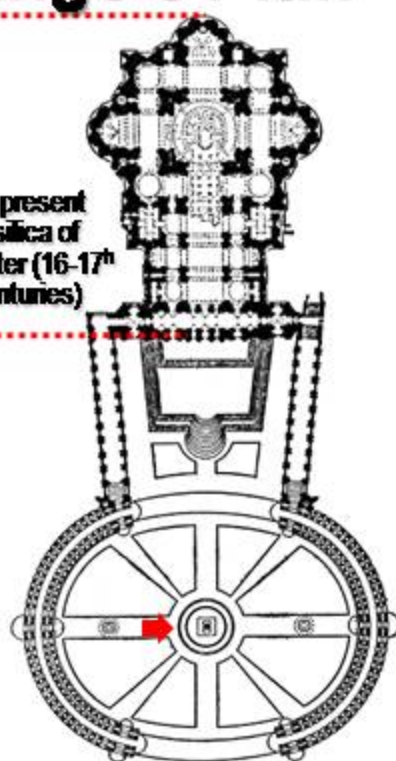

hypothetical reconstruction of the Circus Maximus



the early basilica of St Peter (4th Century)





# ST Peter's Basilica Change's Plan



The stadium (Circus) of Gaius (1st Century)

the early basilica of St Peter (4th Century)

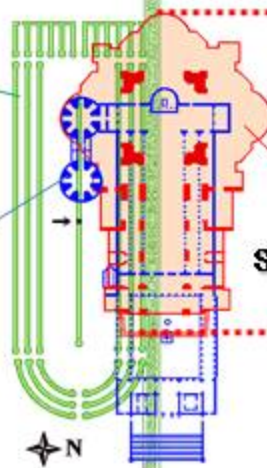

the present basilica of St Peter (16-17th Centuries)

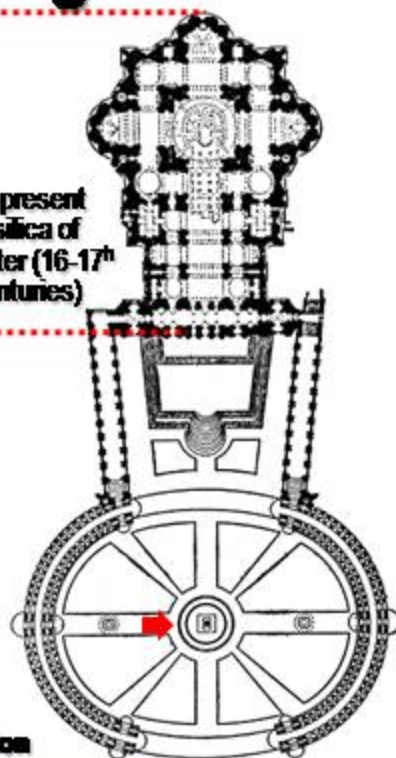

Obelisk at early basilica of St Peter (4th C)

Obelisk at Present Position







# Understanding the local context



*Lho bangunan apa ini?  
Mana lokal konteksnya?  
Bagaimana nih konsep  
Infill designnya?*

Ini namanya  
“Dancing House”  
Karya Frank  
Gehry.... Di kota  
bersejarah Praha

# Dancing House, Prague

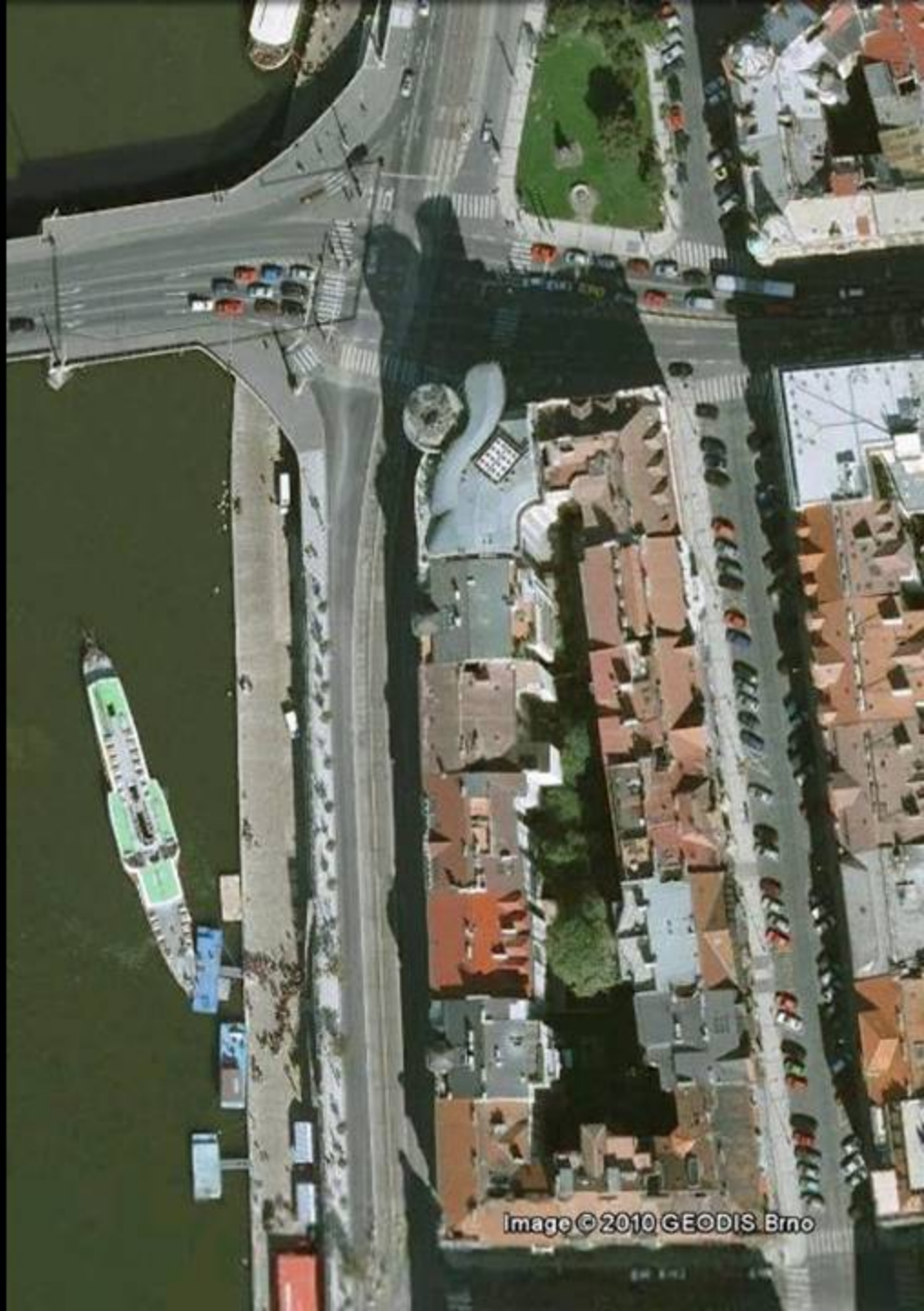

Image © 2010 GEODIS Brno



# Dancing House, Prague





# Jewish Museum, Berlin

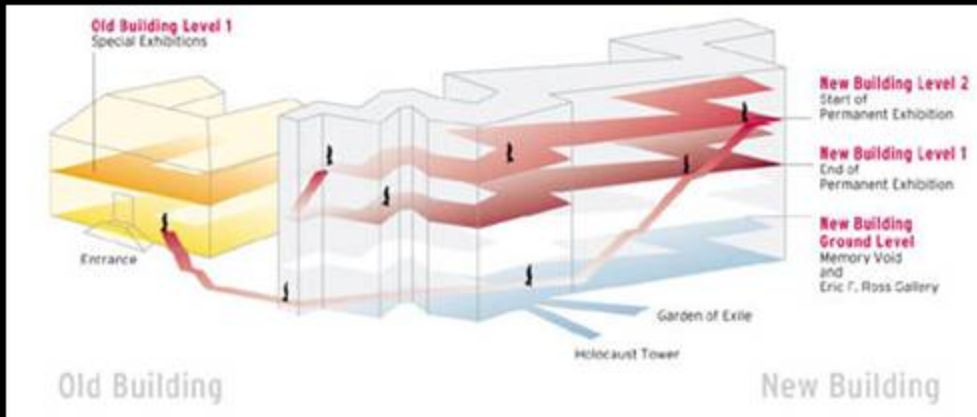

Image © 2010 AeroWest

52°30'05.14" N 13°23'42.87" E elev. 37 m



# Jewish Museum, Berlin





# Wexner Center of Arts, Ohio



Imagery Date: Mar 4, 2004

40°00'02.33"N 83°00'33.51"W elev: 230m



# Wexner Center of Arts, Ohio





*“Infill Development”* yang berskala  
kawasan ada contohnya gak?



*Urban Infill* yang berupa Kawasan  
biasanya disebut dengan *“Revitalisasi  
Kawasan Bersejarah”*...





Apa itu  
***“revitalization”***?

Kalau kita *searching website* banyak  
tuh yang kita dapat... contohnya  
*Revitalization, bringing again into  
activity and prominence;*

We lah sampeyan  
sinten... “Opo rek artine?”

mmmm...saya... mahasiswa Ull..... Artinya tuh....  
Pokoknya bikin kembali situasi yang “aktif berkegiatan”  
dan “kejayaan”



Apa itu  
***“revitalization”***?

Kalau kita searching website banyak  
tuh yang kita dapat... contohnya  
*Revitalization, bringing again into  
activity and prominence;*

“Opo rek artine?”

mmmm... Pokoknya bikin kembali situasi yang “aktif  
berkegiatan” dan “kejayaan”





Lho mengapa sih kok suatu kawasan  
perlu dilakukan  
***“revitalization”***?

Konon sih... *when a  
neighborhood in decline  
is given new life or vigor.*

[www.mrktusa.com/glossary.htm](http://www.mrktusa.com/glossary.htm)

Ooh,..... Jadi kalau suatu kawasan  
mengalami degradasi kualitas  
lingkungan perlu diberi “kehidupan  
baru”, “energi baru” atau diberi  
“VITALITAS lagi” ya..!!??

Wah sampeyan tambah SMART.....



Reichstagsgebäude

Berlin

# Reichstag



Berlin

Das Reichstagsgebäude.



# Reichstag fire & "the terrorist"—the communist

[Smallpox](#) | [External Threat](#) | [Health Powers Act](#) | [FEMA Laws](#) | [Secret Government](#)

## The External Threat = order from chaos The formula for creating the New World Order

Below is the German Reichstag - it is said (Rise and Fall of the Third Reich) that Hitler burned his own capital building in order to coerce the Germans into giving him a totalitarian state.



The Reichstag fire - Germany 1933

same pattern. Instead of Muslims the Nazis placed blame on the Communists to a world war resulting in the deaths of over 50 million humans and the rest of our world.

The Nazis burned the capital building, Reichstag, in 1933 a few months after taking power. They used the catastrophe to fuel sentiment to start a war against terrorism. In 1933 the term "the Communist" in America then were Muslims. A tragedy far surpassed the Reichstag, but the same pattern.

This is an excerpt from the 1997 book, "The Grand Chessboard" by Zbigniew Brzezinski - founder of the Trilateral Commission and a member of several other globalist think tanks:

**"As America becomes an increasingly multicultural society, it may become more difficult to fashion a consensus on foreign policy issues, except in the circumstance of a truly massive and widely perceived direct external threat."**

Is the War on Terrorism the external threat that Brzezinski speaks of? 9/11 was the spark that ignited the War, but the kindling had been building for years. I will not go into details here, but...

## JOIN THE WAR



## AGAINST TERRORISM



entered Los Angeles to restore order. It is true if they were told that there

# Reichstag Bombing & Burning



Sources: [http://www.schicklerart.com/auto\\_exh/Khaldei](http://www.schicklerart.com/auto_exh/Khaldei)



# Reichstag & Communist Flag



# Reichstag & Communist Flag

Yevgeni Khaldei/Fotografer

Sources: <http://www.libraries.psu.edu/maps/photo/18-Reichstag.jpg>



18. Berlin, Germany - May 2, 1945  
The Reichstag, Germany's parliament building, falls to the Soviets.  
World War II ends and the Cold War begins.





WRAPPED REICHSTAG (CHRISTO & JEANNE-CLAUDE), 1995, PHOTOGRAPH BY MICHAEL OBERMAYER, MUSEUM OF MODERN ART, NEW YORK

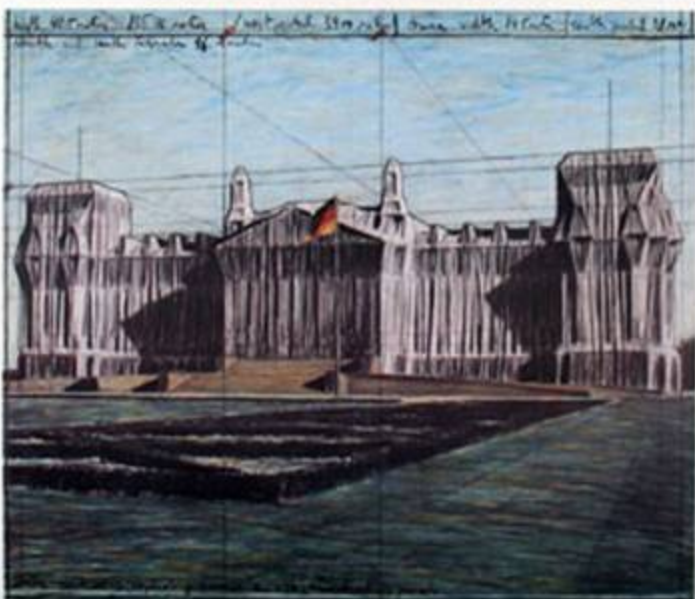

## Wrapped *Ruin* Reichstag (1995)



Christo & Jeanne-Claude



# Wrapped Reichstag & two week long festival

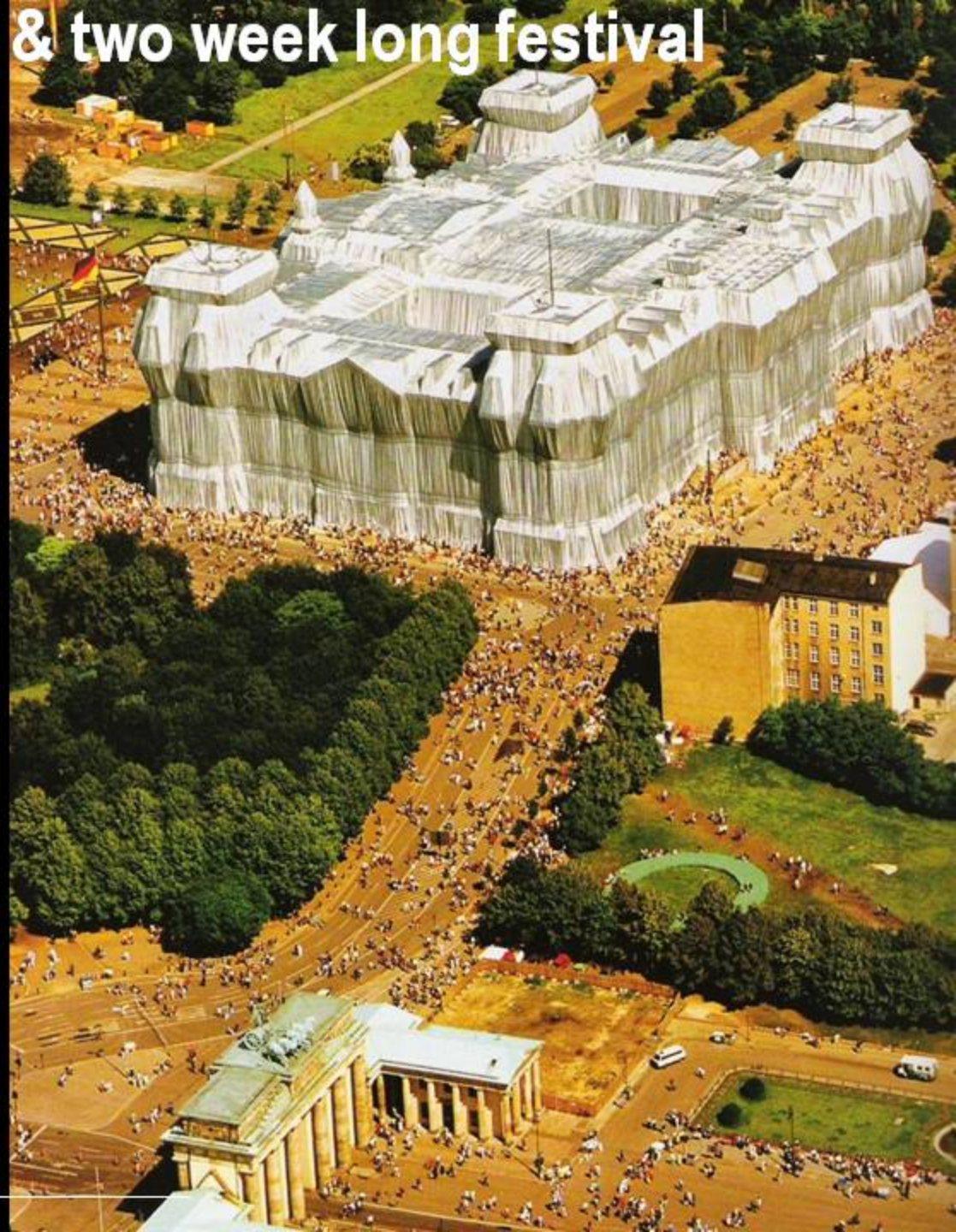



# Reichstag Site Plan

IKAPUTRA, 22 JULY 2009, PRESENTATION FOR PUBLIC WORK

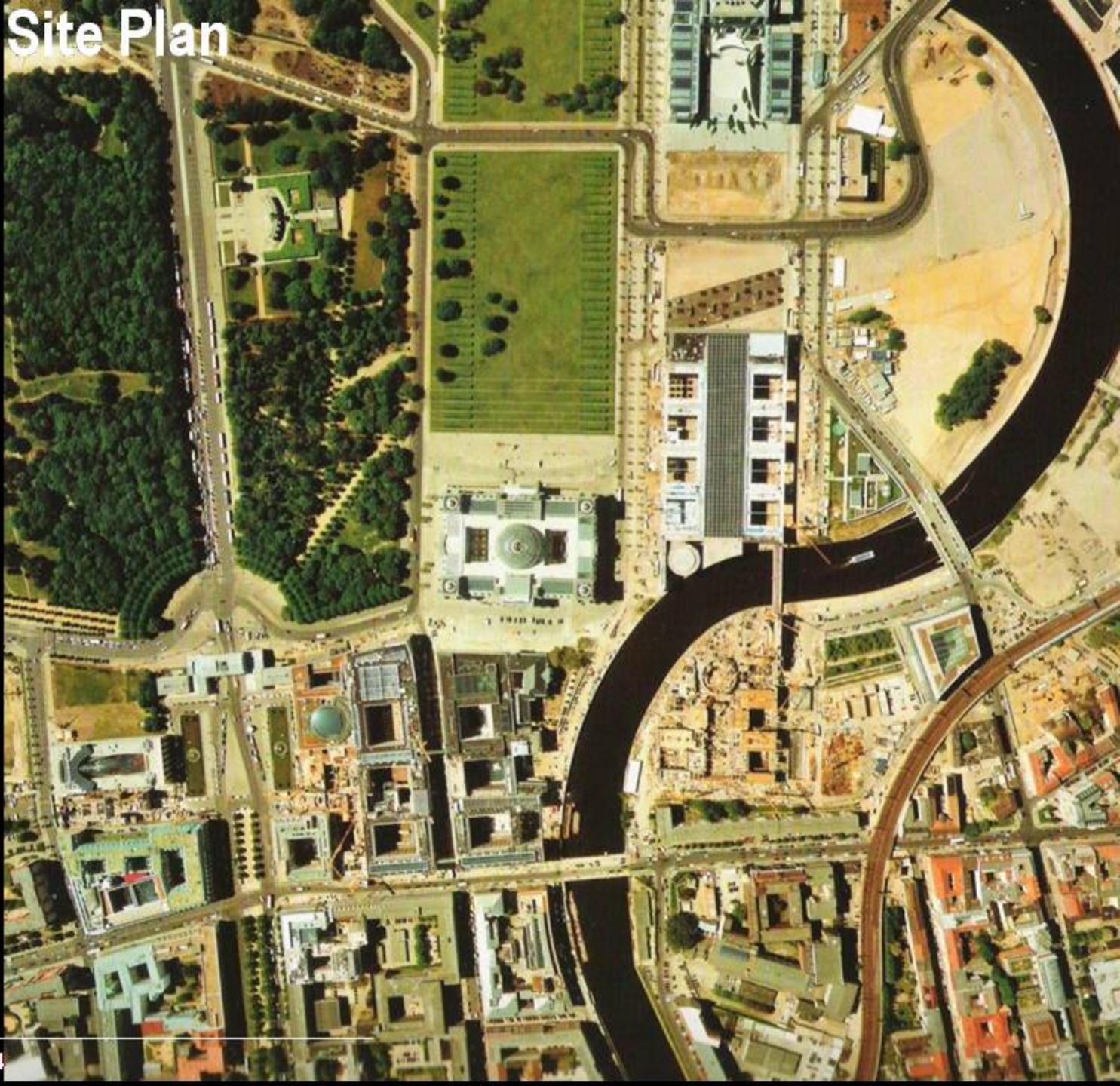

BOOK: NORMAN FOSTER WORK 4



# Reichstag Site Plan





# Reichstag Parliament Chamber

IKAPUTRA, 22 JULY 2009, PRESENTATION FOR PUBLIC WORK

BOOK: NORMAN FOSTER WORK 4





# Reichstag Parliament Chamber

IKAPUTRA, 22 JULY 2009, PRESENTATION FOR PUBLIC WORK





# Reichstag Parliament Chamber

IKAPUTRA, 22 JULY 2009, PRESENTATION FOR PUBLIC WORK



Totipotency  
M. Prosser  
15. 6. 98  
Roth 8/ Kadi 19



# Reichstag & its Cupola Design Studies

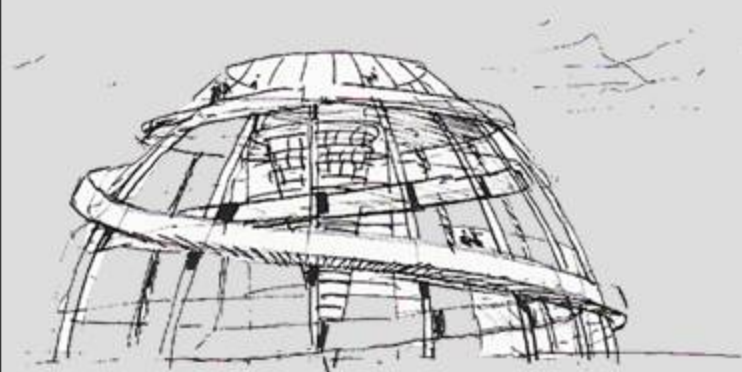
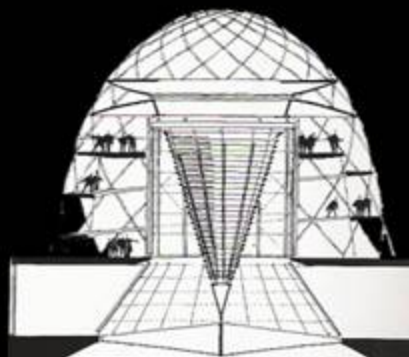
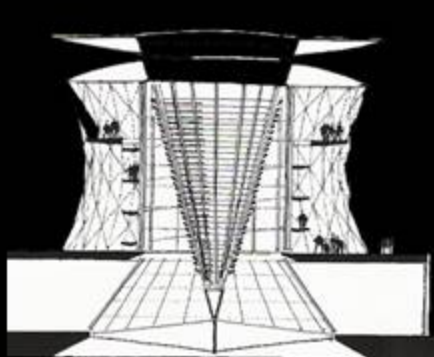

WORK

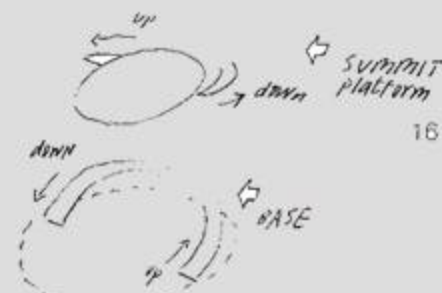
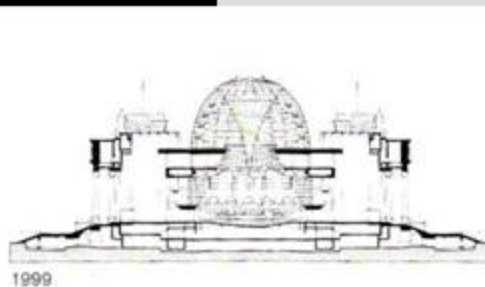
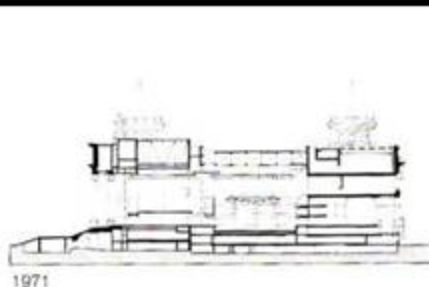
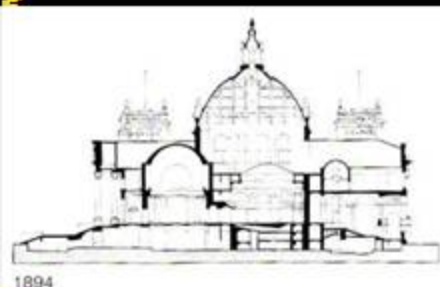

16

IKAPUTRA, 22 JULY 2009, PRESENTA

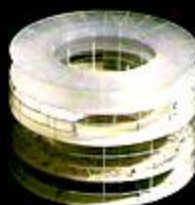
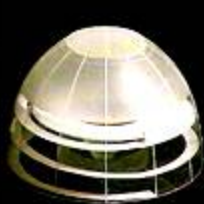

- 1 There are two ramps
- 2 an inner ramp
- 3 and an outer ramp.
- 4 One is for up movement only
- 5 The other is for down only.

if you're in the  
apartment  
it's like easy  
& interpret  
it's a  
similarity  
from  
upper  
platform  
down  
to ramp  
at level.

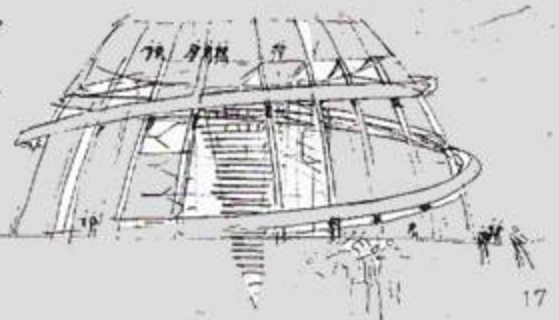

17



# Reichstag & its Cupola Design

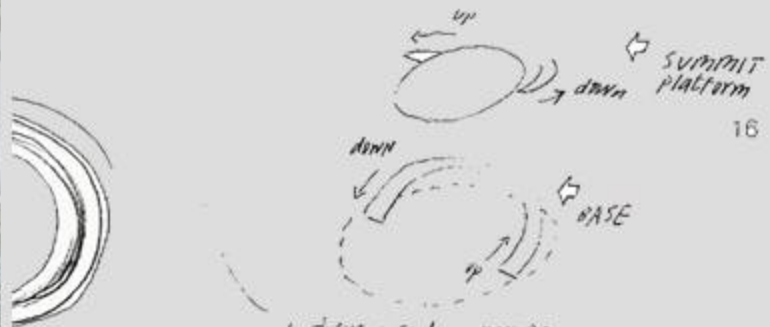
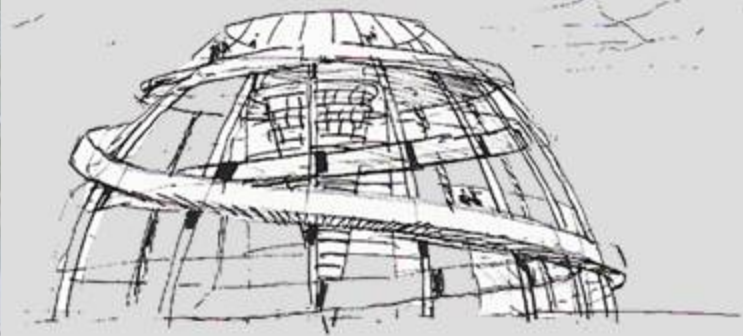

- 1 There are two ramps
- 2 an inner ramp
- 3 and an outer ramp.
- 4 One is for up movement only
- 5 The other is for down only.

if people in the  
apartment  
it will be easy  
to interpret  
the  
structure  
from  
upper  
platform  
and  
is very  
easy to read.

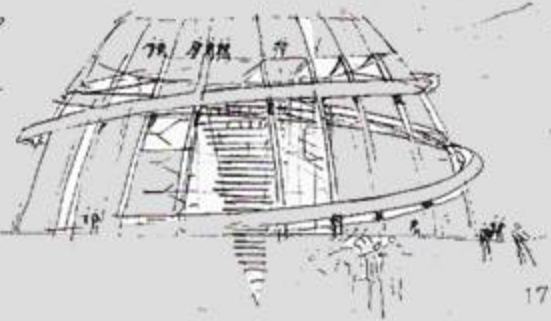



# Reichstag & its Cupola





# People, Reichstag & its Cupola





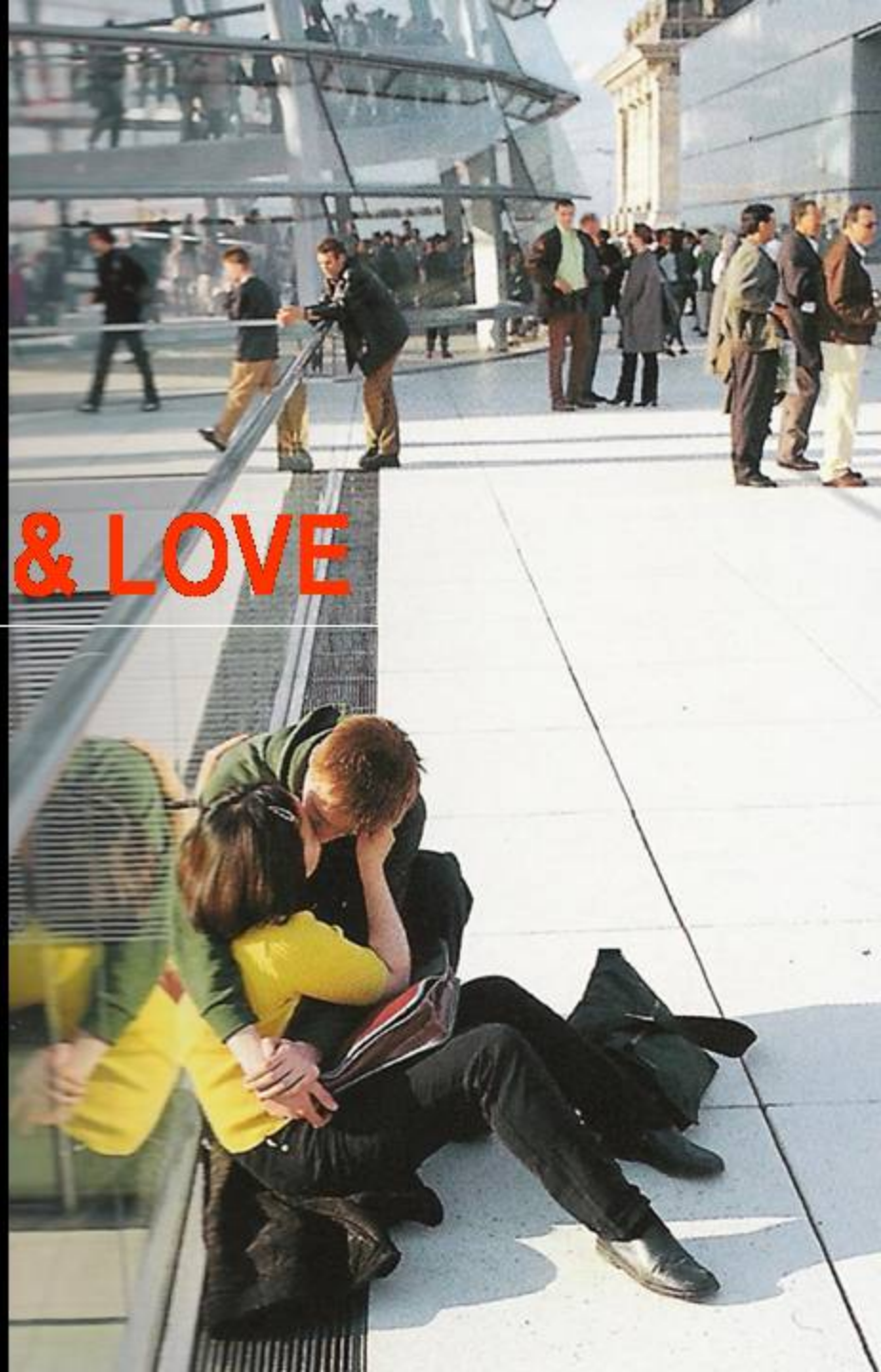

# Reichstag & LOVE







Lalu apa tujuan "*revitalization*"? Kasih tenaga baru,...  
*doping* kawasan gitu...??



Wah sampeyan kok tanya terus sih..... Well...,  
*Revitalization is aimed to guarantee their  
well being & continued presence in the  
public domain as useful elements in our  
economic & cultural systems.*

[www.m-aan.org/Web\\_mAAN/mAAN\\_2003\\_Session.htm](http://www.m-aan.org/Web_mAAN/mAAN_2003_Session.htm)

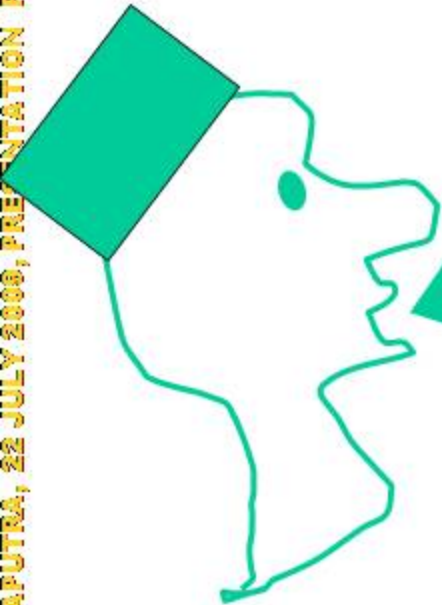

Wah... berarti kita perlu menjamin  
keberadaan dan keberlangsungannya  
namun harus punya manfaat bagi  
masyarakat baik secara ekonomi  
maupun sistem budaya

# GAZOMETER VIENNA 1915





# GAZOMETER VIENNA CHANGE

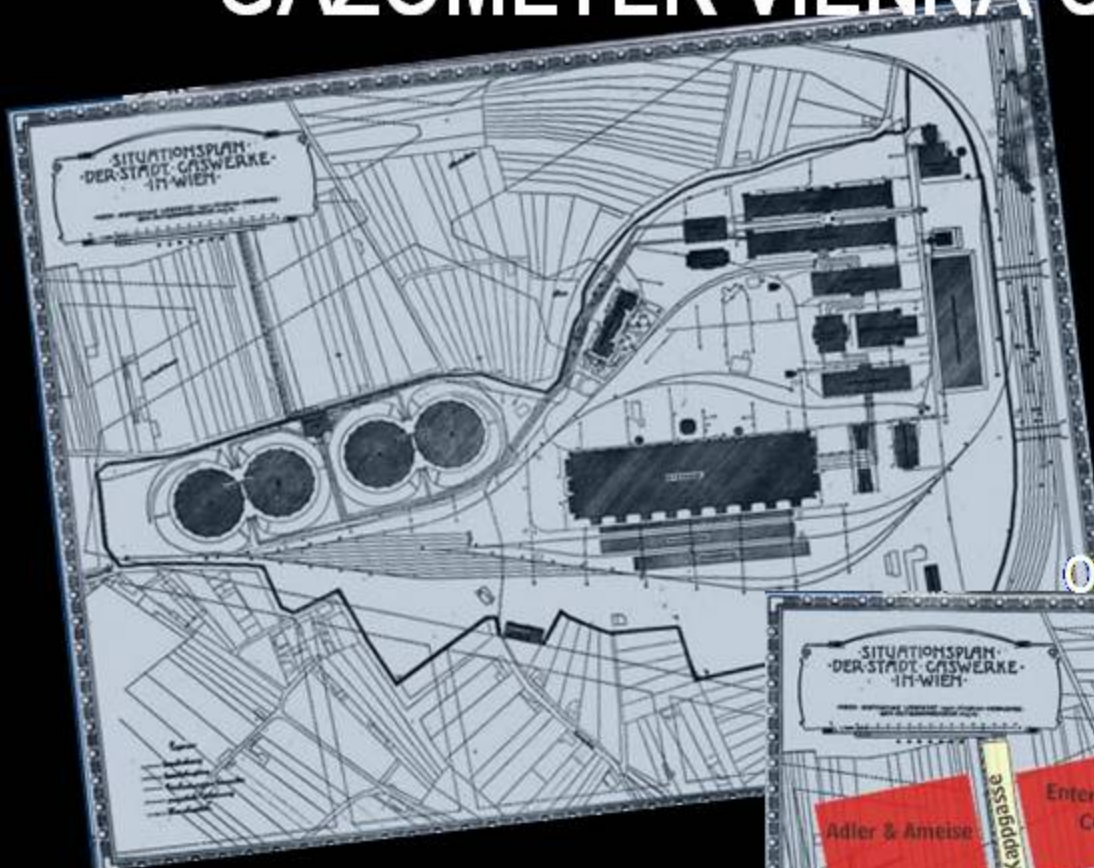

1902 (built in 1886-1899)

1970-1978 (gas supply obsolete)

2001



Ongoing Revitalization 1995





# GAZOMETER VIENNA Revitalization

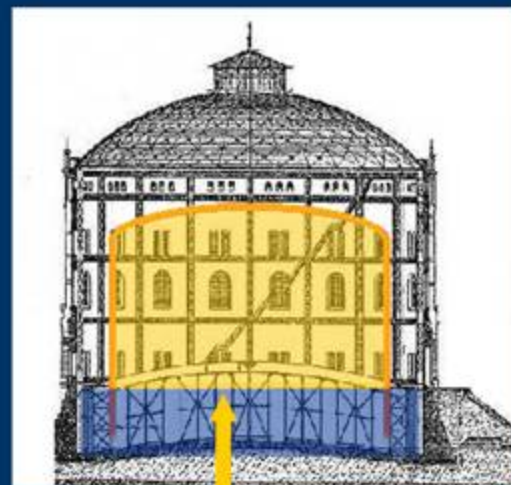

Gaswerk

Gas wird vom Gaswerk im  
Gasometer gespeichert

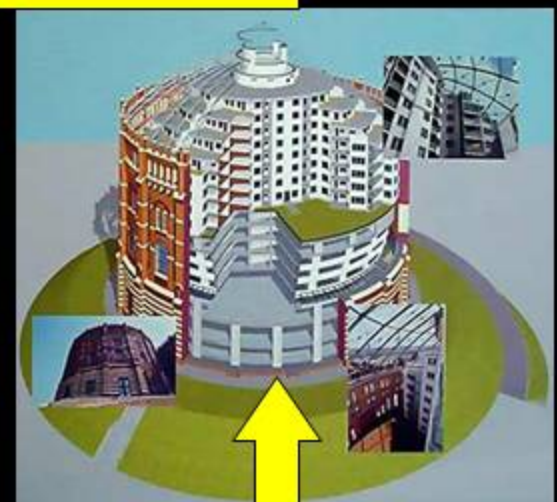



# GAZOMETER VIENNA



[www.Gasometer.org](http://www.Gasometer.org)

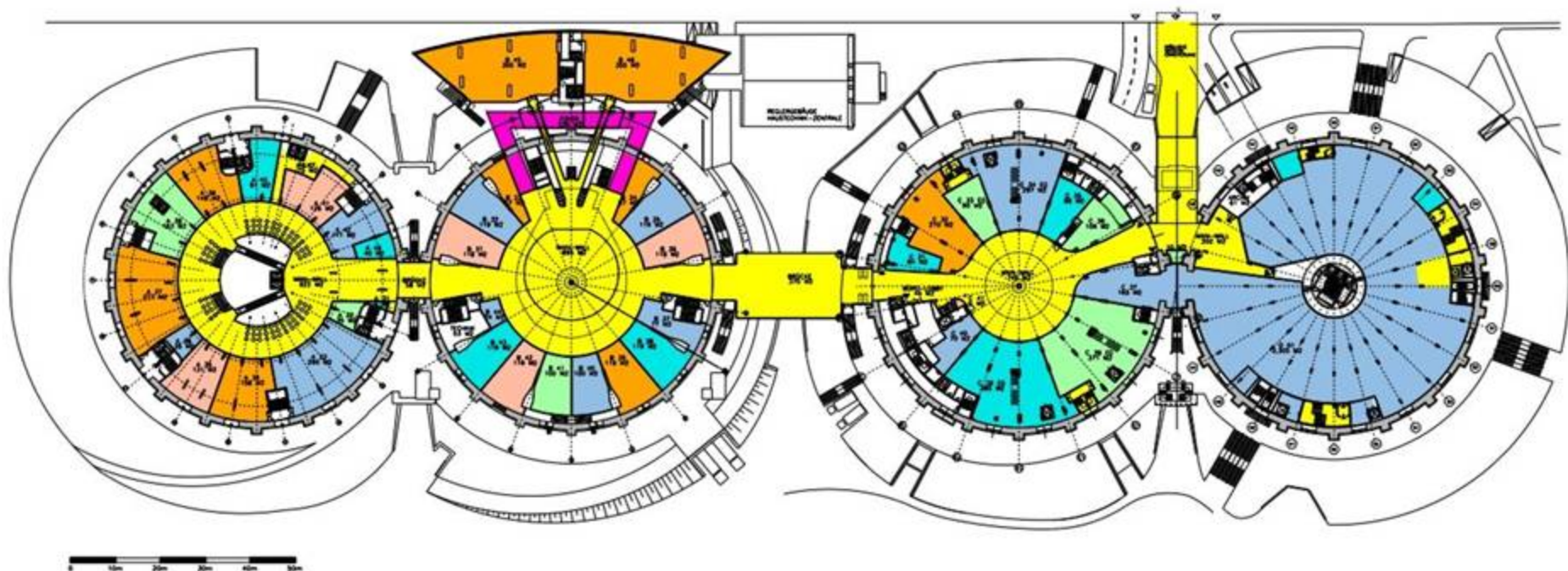

# GAZOMETER VIENNA'S GATE





# GAZOMETER VIENNA

*Jean Nouvel*

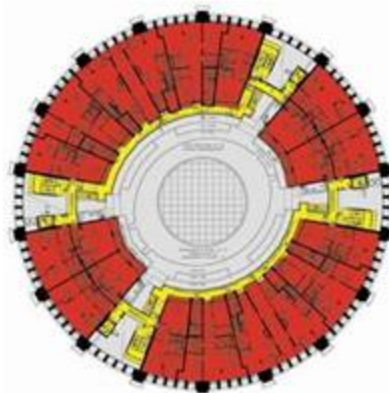
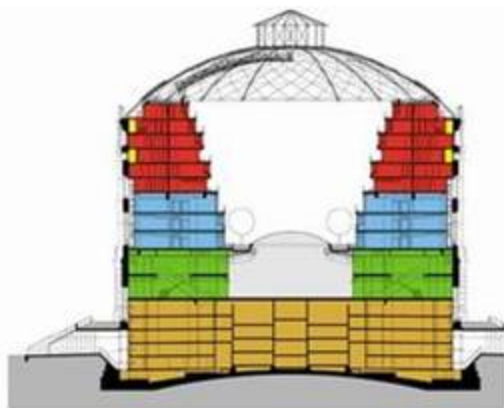



# GAZOMETER VIENNA COOP HIMMELBLAU

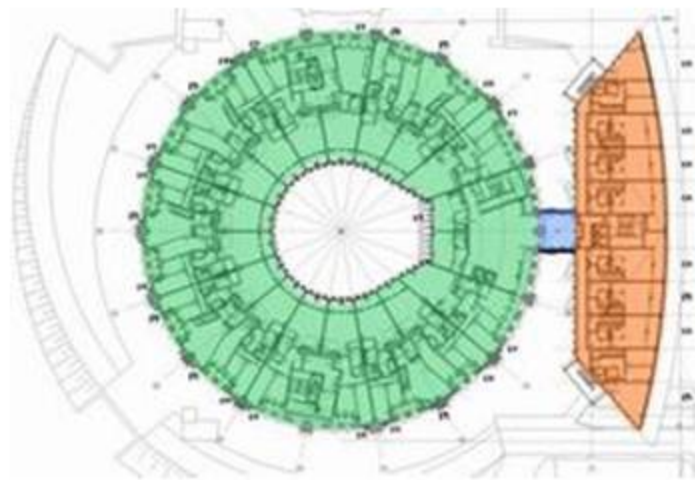
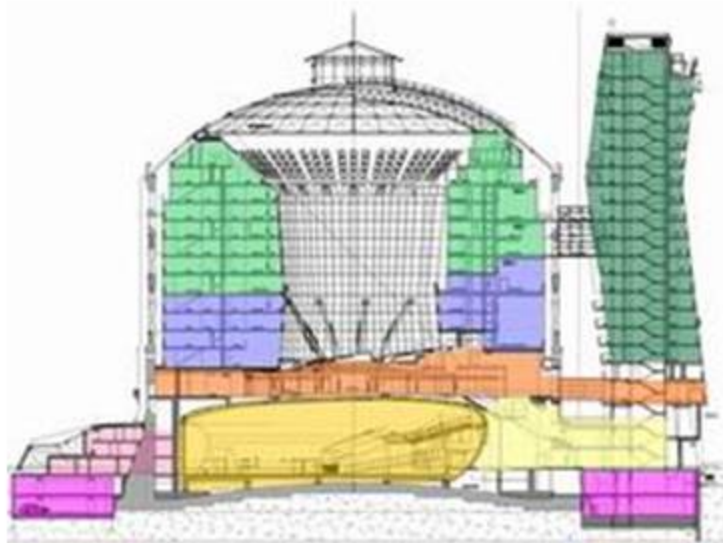



# GAZOMETER VIENNA COOP HIMMELBLAU



# GAZOMETER VIENNA COOP HIMELBLAU

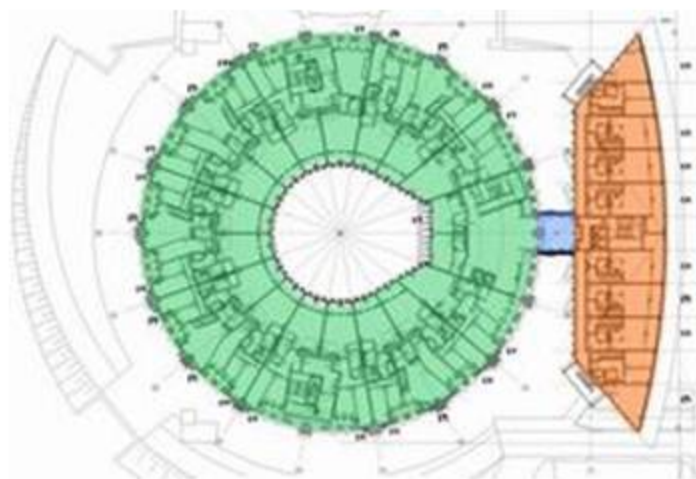
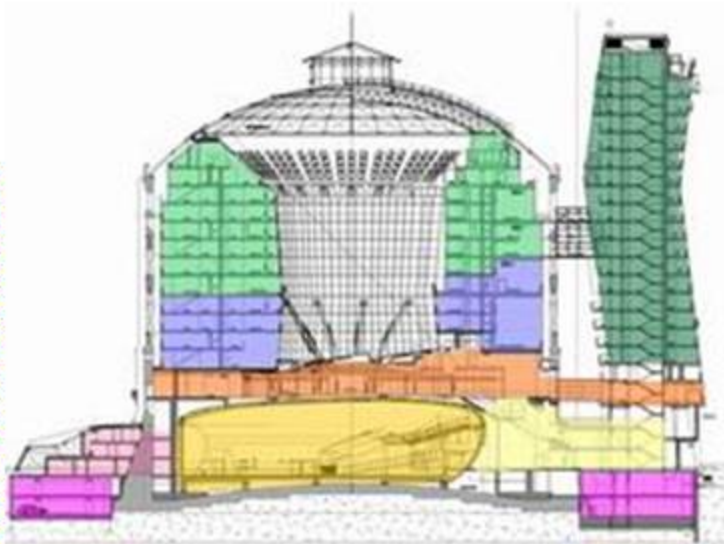





**GAZOMETER VIENNA**

# GAZOMETER VIENNA





# GAZOMETER VIENNA



APUTRA, 22 JU

**BACK TO TREES**



Konkretnya proses "**revitalisasi**" itu gimana sih?

Revitalisasi itu semacam proses pengembangan kembali ekonomi, sosial dan budaya dari suatu kawasan publik dan pemukiman.  
[www.heritagebc.ca/terms.htm](http://www.heritagebc.ca/terms.htm)

Lha hubungannya dengan arsitektur dan urban heritage apa???

Heritage area revitalization concentrates on historic buildings & other heritage resources to achieve economic, social & cultural objectives.  
[www.heritagebc.ca/terms.htm](http://www.heritagebc.ca/terms.htm)

Oh... jadi tetap aja tujuannya untuk pengembangan Ekonomi, sosial & budaya ya

Exactly.....!!



# Kaiser-Wilhelm Gedachtnis-kirche



**Emperor Wilhelm's Memorial Church  
(Berlin, Germany), around 1900**

Sources: [www.commonswikimedia.org](http://www.commonswikimedia.org)

# Kaiser-Wilhelm Gedachtnis-kirche

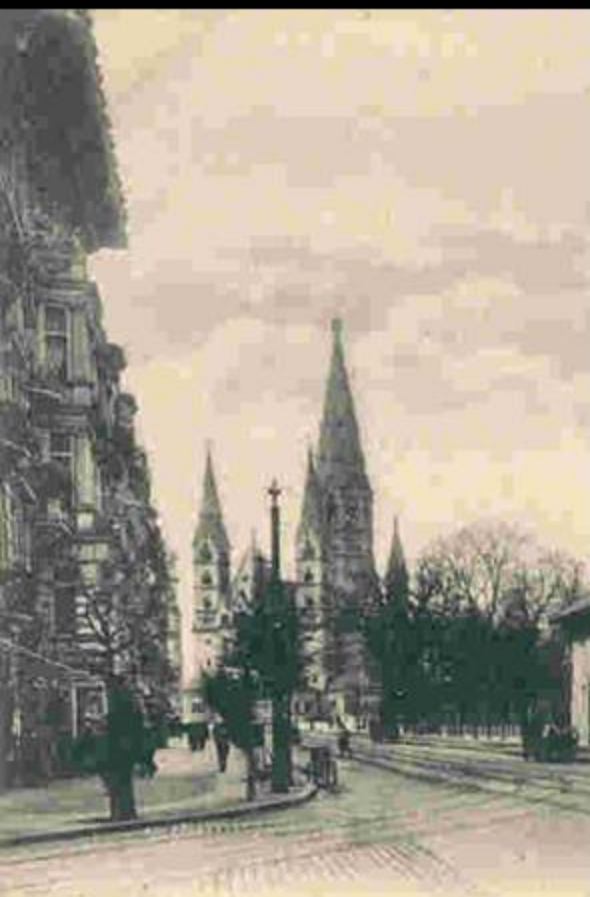

*Berlin*



*Haupteingang zum Zoologischen Garten*

**Berlin Zoo main entrance with Kaiser Wilhelm Memorial church in background**

Sources: [hometown.aol.com/germanpostcards/page2.html](http://hometown.aol.com/germanpostcards/page2.html)



# Kaiser-Wilhelm Gedachtnis-kirche



**Berlin: Potsdam und Die Kurmark.**

**Kaiser Whilhelm Memorial Church, circa 1932, by Mark Vandeneschen.**

**Travel Brochure published by the Reichsbahnzentrale für den Deutschen Reiseverkher, Berlin.**

Sources: [http://www.travelbrochuregraphics.com/Germany\\_Pages/Germany\\_1/BerlinPotsdamunddiekurmark.htm](http://www.travelbrochuregraphics.com/Germany_Pages/Germany_1/BerlinPotsdamunddiekurmark.htm)

***Berlin Zoo main entrance with Kaiser Wilhelm Memorial church in background***

Sources: [hometown.aol.com/germanpostcards/page2.html](http://hometown.aol.com/germanpostcards/page2.html)

# Kaiser-Wilhelm Gedachtnis-kirche



STWAR

## Emperor Wilhelm's Memorial Church Bombing

Sources: [www.berlin280.com/pgberlin.htm](http://www.berlin280.com/pgberlin.htm). Fotografer: Bill Gunter



# Kaiser-Wilhelm Gedachtnis-kirche



**Emperor Wilhelm's Memorial Church Bombing**

Sources: [www.trumanlibrary.org/whistlestop/BERLIN\\_A/](http://www.trumanlibrary.org/whistlestop/BERLIN_A/)

# Kaiser-Wilhelm Gedachtnis-kirche



**NEW LIFE OF THE BOMBING CHURCH  
GROUND**

SOURCES: Laubner (2001) BERLIN. Aus Der Luft Fotografiert





# Kaiser-Wilhelm Gedachtnis-kirche



Image © 2010 AeroWest

Imagery Date: May 5, 2006 52°30'17.00" N 13°20'07.53" E elev 39 m



© 2009 Google

Eye alt 500 m

**NEW LIFE OF THE BOMBING CHURCH GROUND**  
SOURCES: Google Earth.



# Kaiser-Wilhelm Gedachtnis-kirche



**OLD & NEW SCAPE**





# Kaiser-Wilhelm Gedachtnis-kirche



*Night life of the Revitalization Area*

©Aidan O'Rourke  
[www.aidancities.com](http://www.aidancities.com)

# Kaiser-Wilhelm Gedachtnis-kirche

*RUINS WITHIN  
NEW ART CULTURE*

IKAPUTRA, 22 JULY 2009, PRESENTATION FOR PUBLIC WORK



Hebat... kawasan yang pernah  
mati di Berlin ini tumbuh  
menjadi kawasan komersial,  
kultural, dan social gathering..





# REVITALISASI POMPIDOE CENTER



# George Pompidou Center



retails

housing

ills

**Pengembangan Sub-urban di kota2 barat (mall & real estate)** (Lord, 1988 In Thomas and Bromley, 2000: 1404) ,  
**menyebabkan pusat kota mati sehingga memunculkan “Gejala Donatisasi kota” (Doughnut Phenomenon)** (Ryu, 1999 : 28-29 dalam Park, 2004: 447)





# George Pompidou Center





# George Pompidou Center





# ITALISASI POMPIDOE CENTER

IKAPUTRA, 22 JULY 2009, PRESENTATION FOR PUBLIC WORK



Ini juga hebat... kawasan yang pernah mati di Paris ini menjadi kawasan Budaya dengan ikutan peningkatan kegiatan ekonomi berbasis kultural..

# REVITALISASI KAWASAN LOUVRE

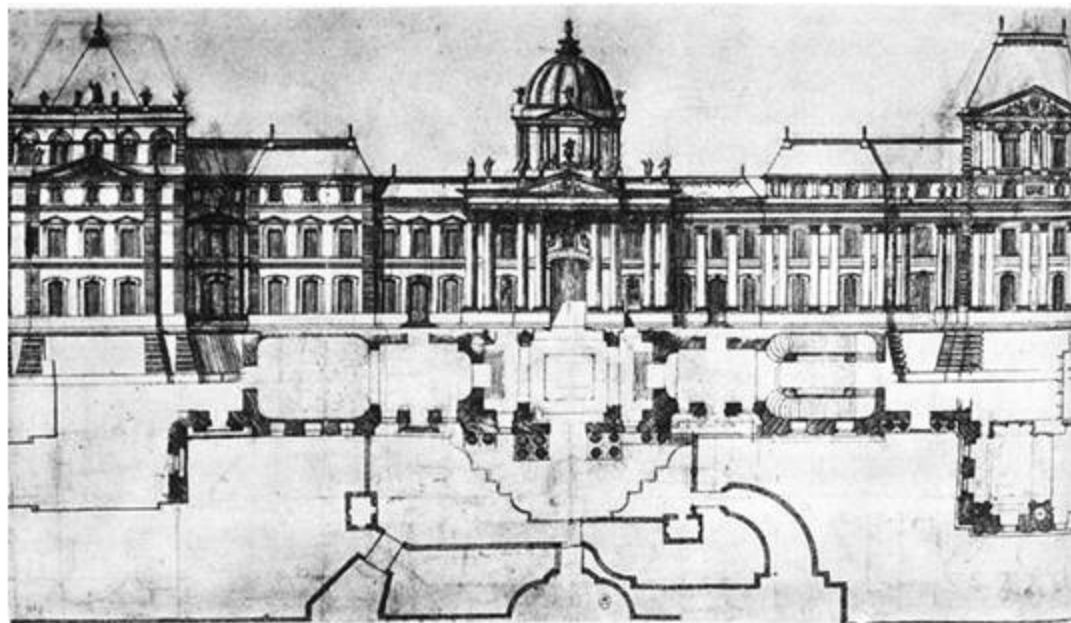
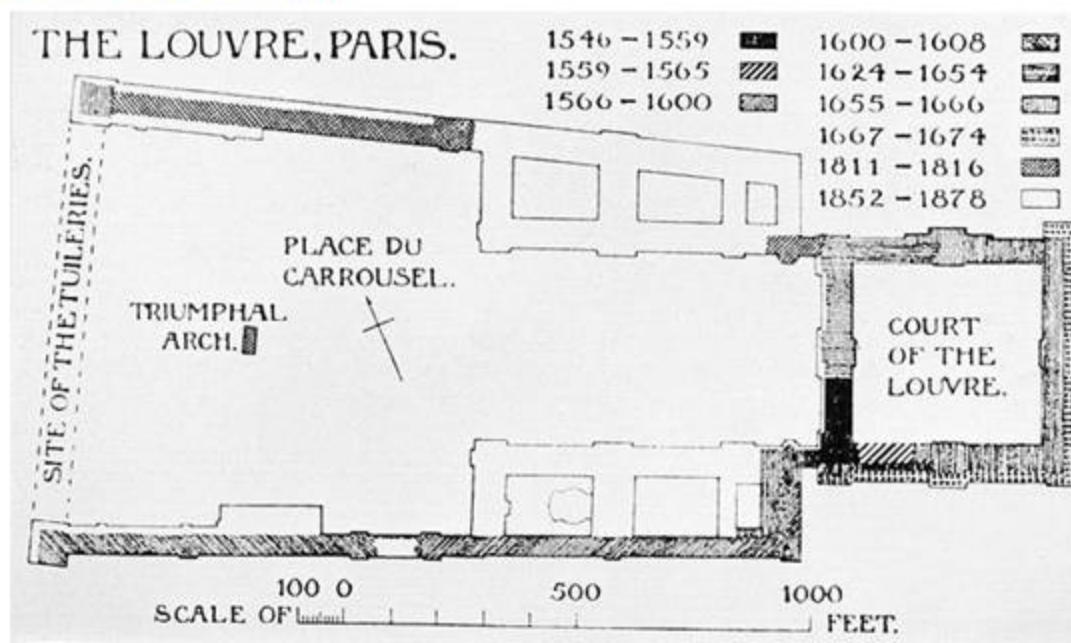

Photo source: [www.musee-louvre.com/en/history/the-louvre](http://www.musee-louvre.com/en/history/the-louvre)





# REVITALISASI KAWASAN LOUVRE



Photo sources: <http://www.wwart.com/asp/sp-asp/>



Photo sources: <http://www.classes.uleth.ca/200302/fa3200x/>



# REVITALISASI KAWASAN LOUVRE



Photo sources: [www.arthistoryclub.com/art-history/The-Louvre](http://www.arthistoryclub.com/art-history/The-Louvre)

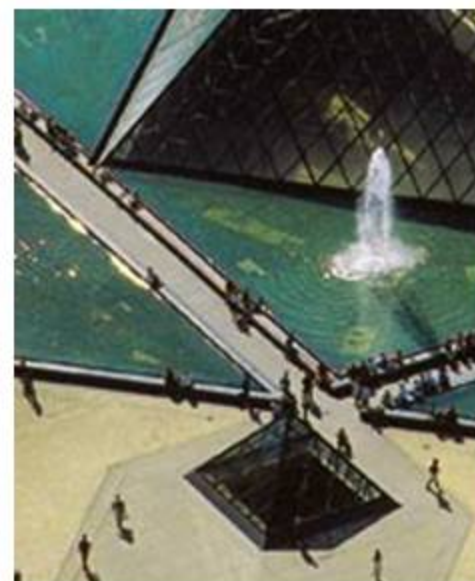
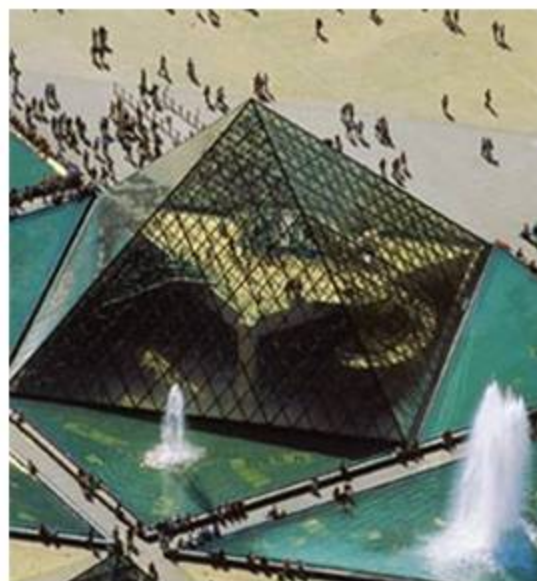
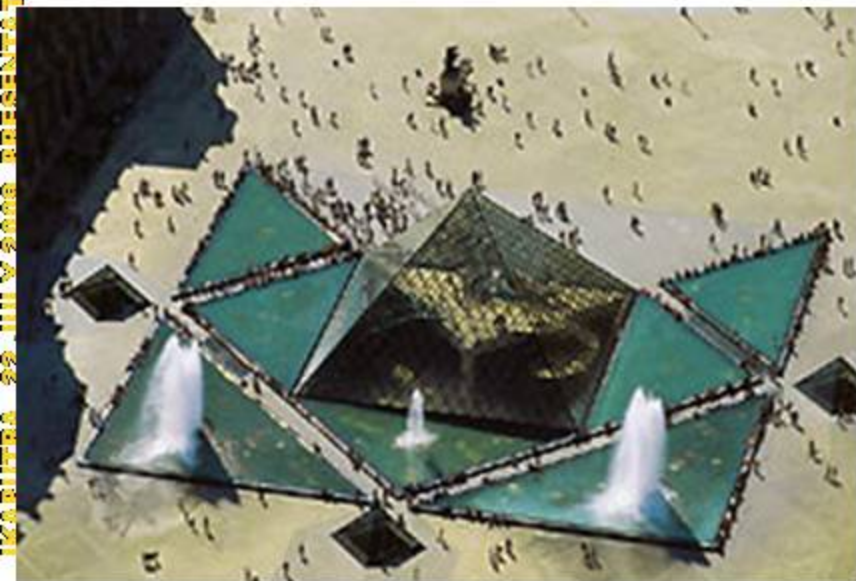

Photo sources: <http://www.yannarthesbertrand.com/es/citerne/part7/chap4/c001.htm>



# REVITALISASI KAWASAN LOUVRE



Kawasan Louvre ini... bahkan murni  
menghidupkan kegiatan kultural tanpa embel-  
embel komersialisasi kawasan yang  
menonjol.. Bangkit kembali kejayaan istana  
louvre dengan vitalitas baru





# COLONES DE BUREN





# COLONES DE BUREN





# COLONES DE BURREN



# DE BUREN

PARIS

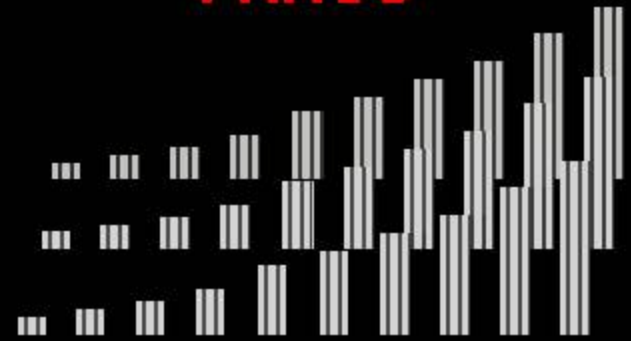

Buren

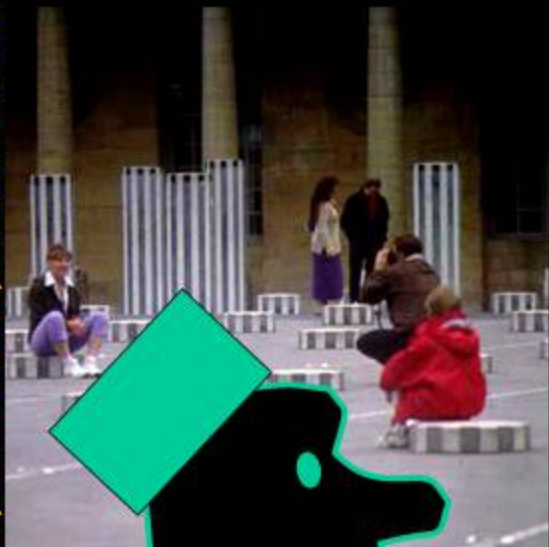

BACK TO TREES

Revitalisasi.. Tanpa komersialisasi....  
Bringing into activity & prominence





Asumsi awalnya kan kawasan **nggak punya Vitalitas** kan!  
**Nggak tertata** juga kan?!!  
Jadi Mestinya, ada **JUSTIFIKASI** dulu?  
Mestinya diungkapkan dulu **Mana yang TIDAK TERTATA & Mana yang TIDAK PUNYA VITALITAS**



Wah hebat.... anda udah bisa bersikap dalam proses justifikasi untuk Revitalisasi



Cari yang mengalami degradasi, tertinggal, kalah bersaing, tidak lagi menarik, vitalitas ekonomi menurun, identitas tradisi/budaya yang memudar, IDENTIFIKASI KAWASAN ITU PENTING

..... Wah kalau diskusinya Ruaaar Biasa....  
Semua mahasiswa Ull jadi arsitek hebat dunk!!....



**Contoh seperti apa, bahwa suatu kawasan  
diidentifikasi sebagai kawasan yang  
mengalami degradasi kualitas?  
Dan bagaimana sikap atau respon untuk  
memberikan vitalitas baru**



Ok, ... ini contoh sederhana... melihat  
suatu tempat yang pernah berfungsi  
baik... kemudian terbakar dan tidak  
berfungsi..



Ok...pengin lihat nih..



# Instant Night Market

Empire  
8





# Instant Night Market

IKAPUTRA, 22 JULY 2009, PRESENTATION FOR PUBLIC WORK





# Instant Night Market





# Instant Night Market





# Instant *Night Market*

IKAPUTRA, 22 JULY 2009, PRESENTATION FOR PUBLIC WORK



# Instant *Night Market*

IKAPUTRA, 22 JULY 2009, PRESENTATION FOR PUBLIC WORK





# Instant *Night Market*

IKAPUTRA, 22 JULY 2009, PRESENTATION FOR PUBLIC WORK





# Instant Night Market





# Instant Night Market





Instant Night Market





# Instant *Night Market*

IKAPUTRA, 22 JULY 2009, PRESENTATION FOR PUBLIC WORK





# Instant Night Market

**Akankah kita kalah  
*SENSITIF* dengan  
pemilik Pasar  
Malam?????**





**Akankah kita kalah  
*SENSITIF* dengan  
pemilik Pasar  
Malam?????**

***Thank You Very Much  
Matur Sanget Nuwun***